

MINIATURE SCENERY

INSTRUCTIONS ARMED PINNACE

PREPARATION

You will need:

- Cutting mat or something to protect your table.
- PVA/Wood glue or superglue if you prefer.
- Small file or sand paper.
- Small blade / hobby knife

GENERAL PROCESS

- Clear plenty of table space, you will need it.
- Parts should remove easily from the board by pressing through and popping them out. It's a good idea to cut through the tiny joins first though, and some parts (particularly smaller, more detailed parts) may need more careful persuasion.
- Use file or sand paper to remove the small bur caused by the connection to the frame.
- It's a good idea to familiarise yourself with how the pieces fit together before gluing.
- Slot the parts together as shown by the pictures below, applying glue wherever there is a connection. (unless shown otherwise)
- Parts may be a very tight fit, slight trimming or sanding of parts may be needed for ease of assembly.

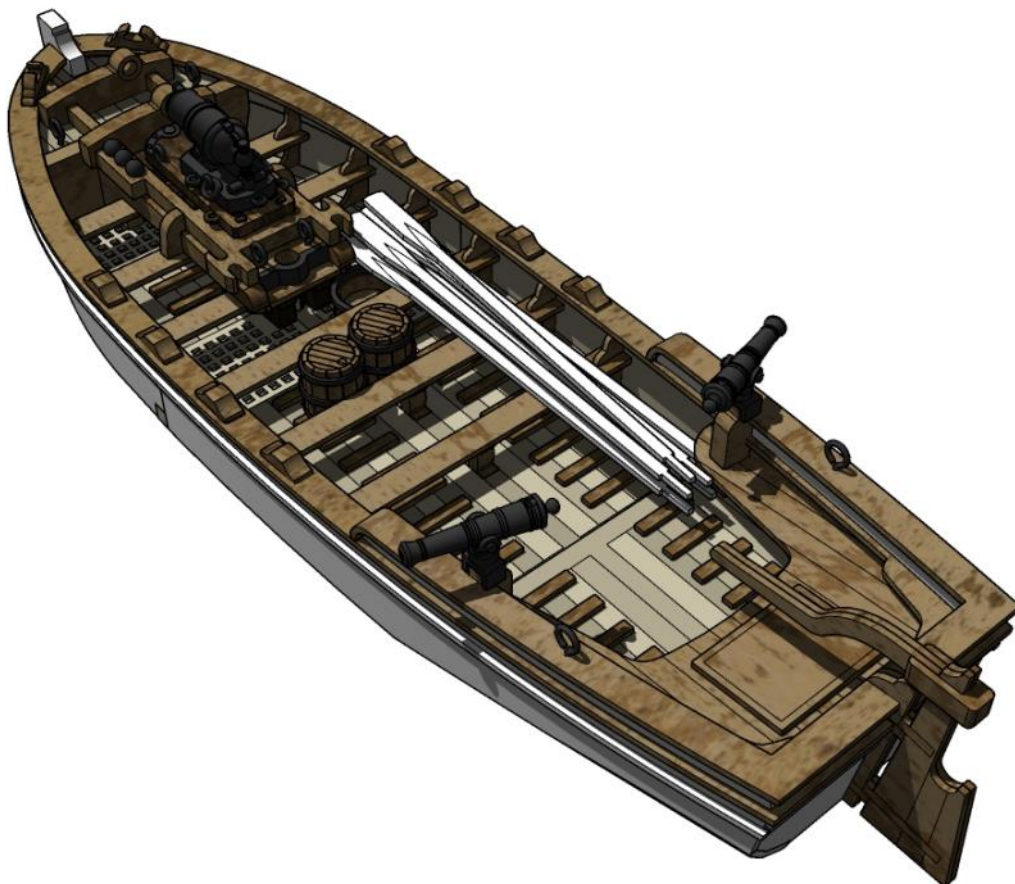

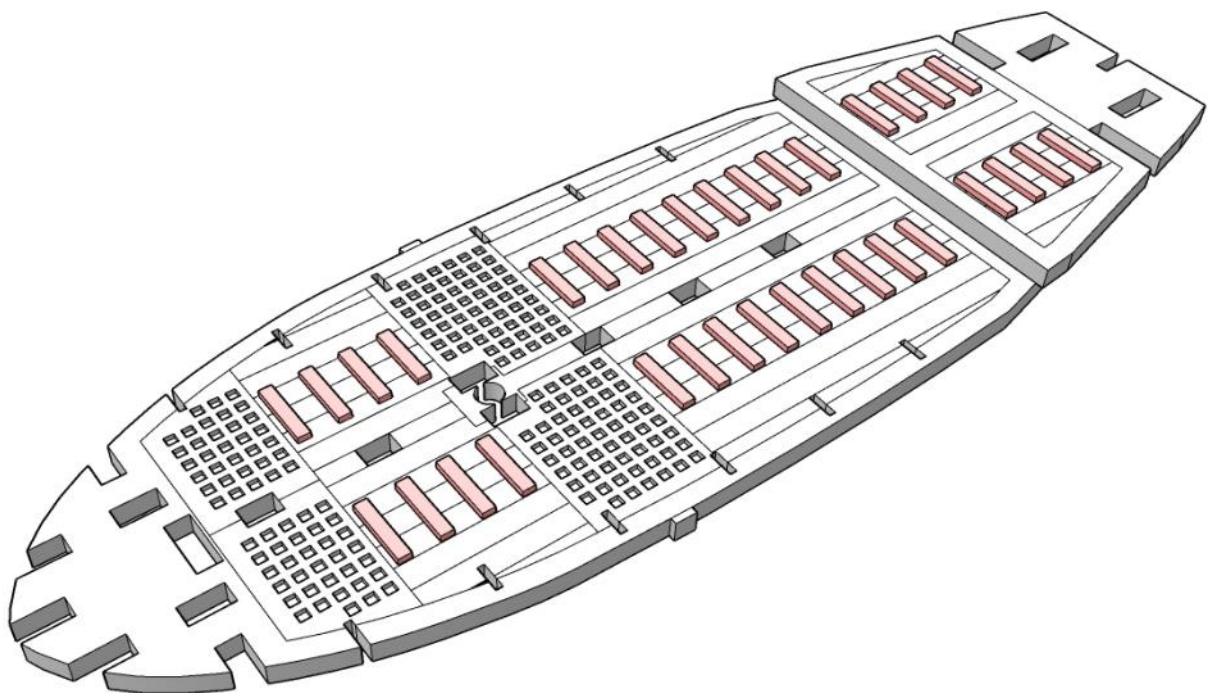
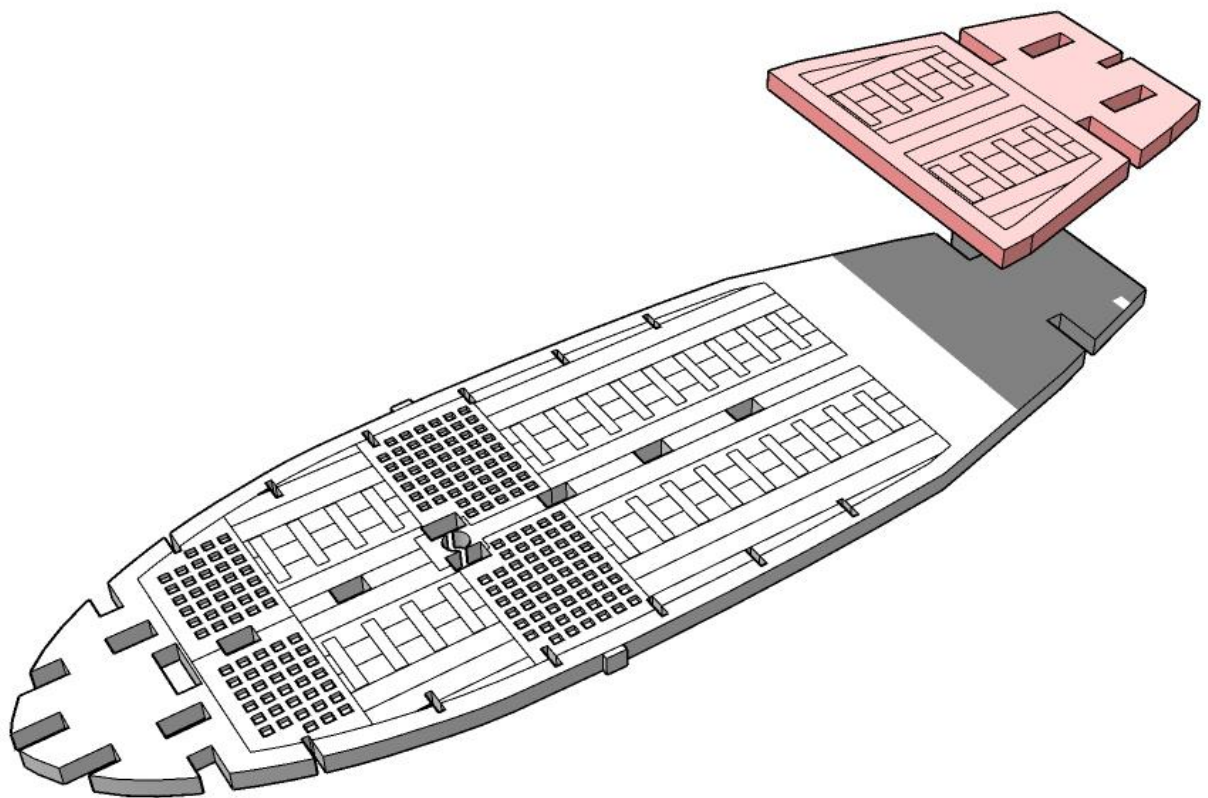

Cut 10mm lengths of the 2mm wide card strip provided. You could elect not to do this, but it does add some extra depth and detail to the model.

MINIATURE SCENERY

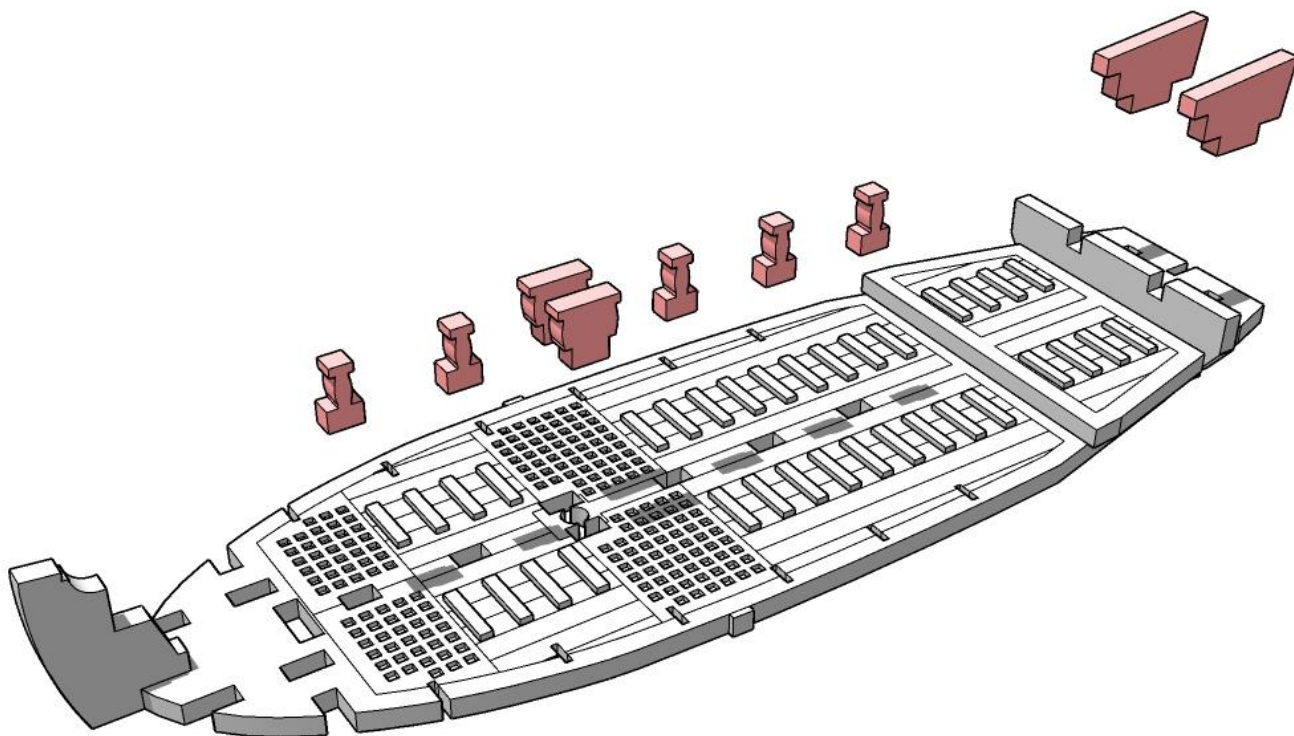
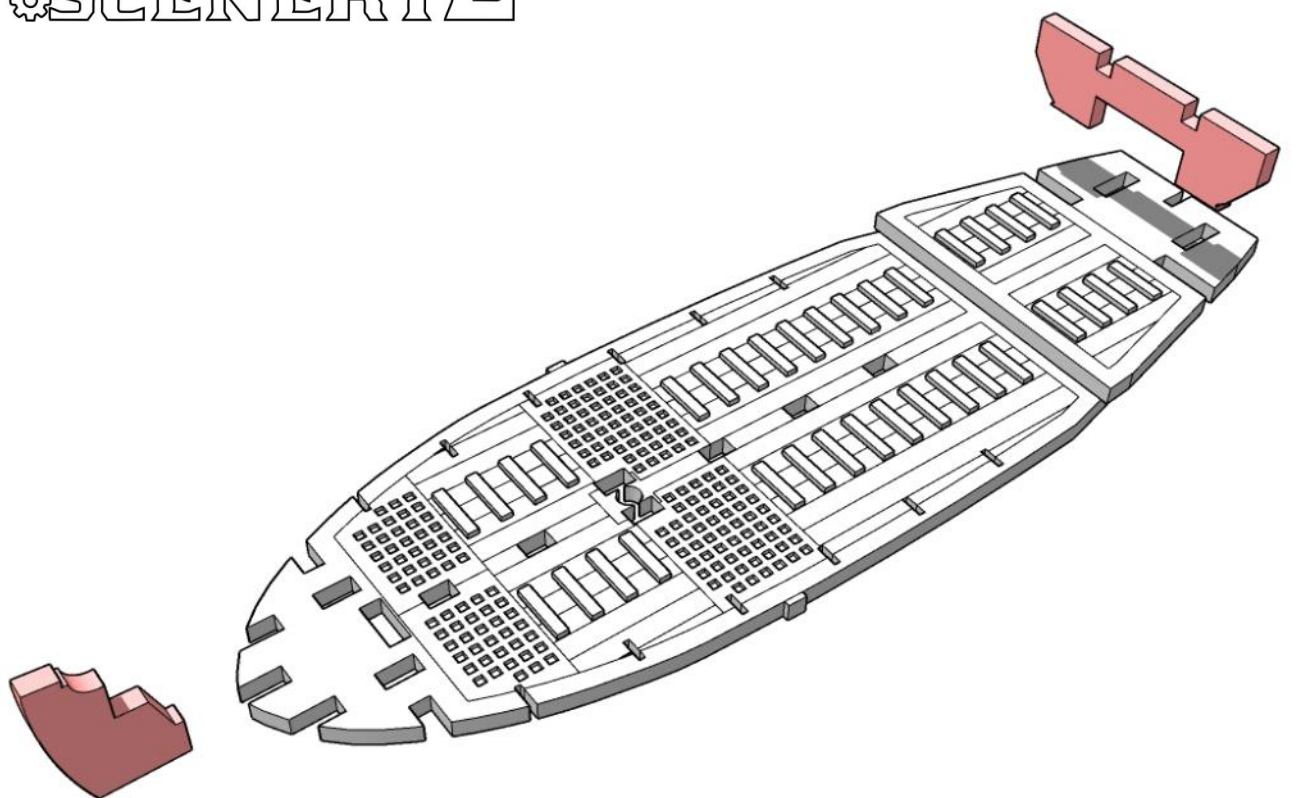

MINIATURE SCENERY

rear

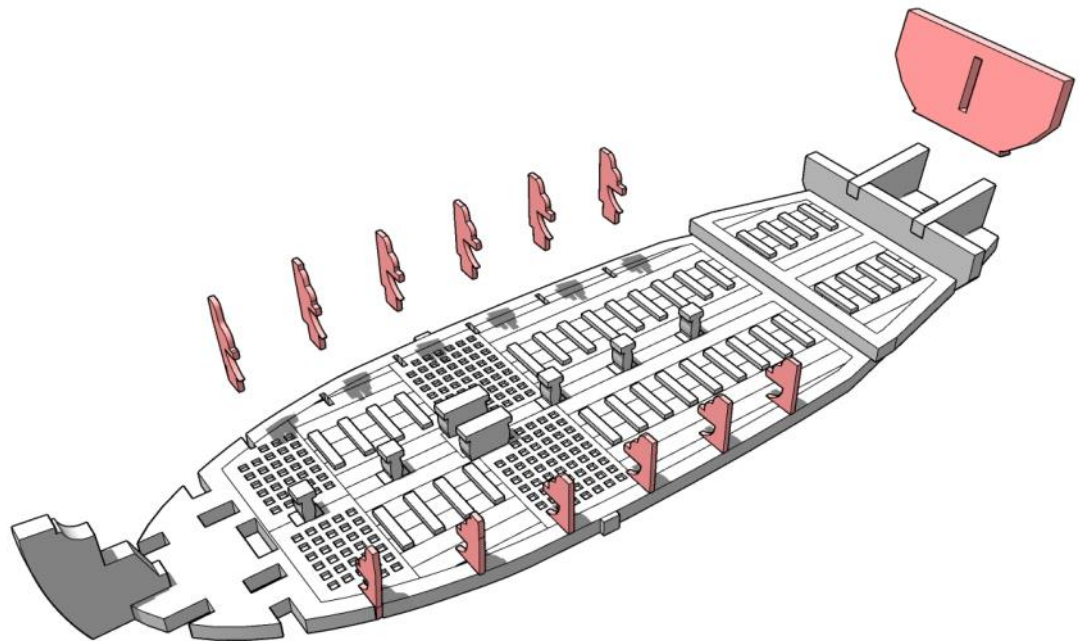
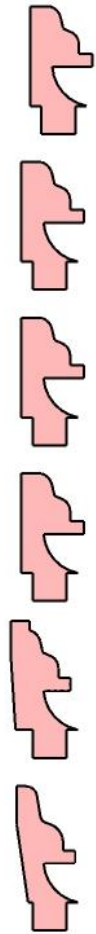

The Ribs are presented in order on the card sheet.

Don't mix them up.

front

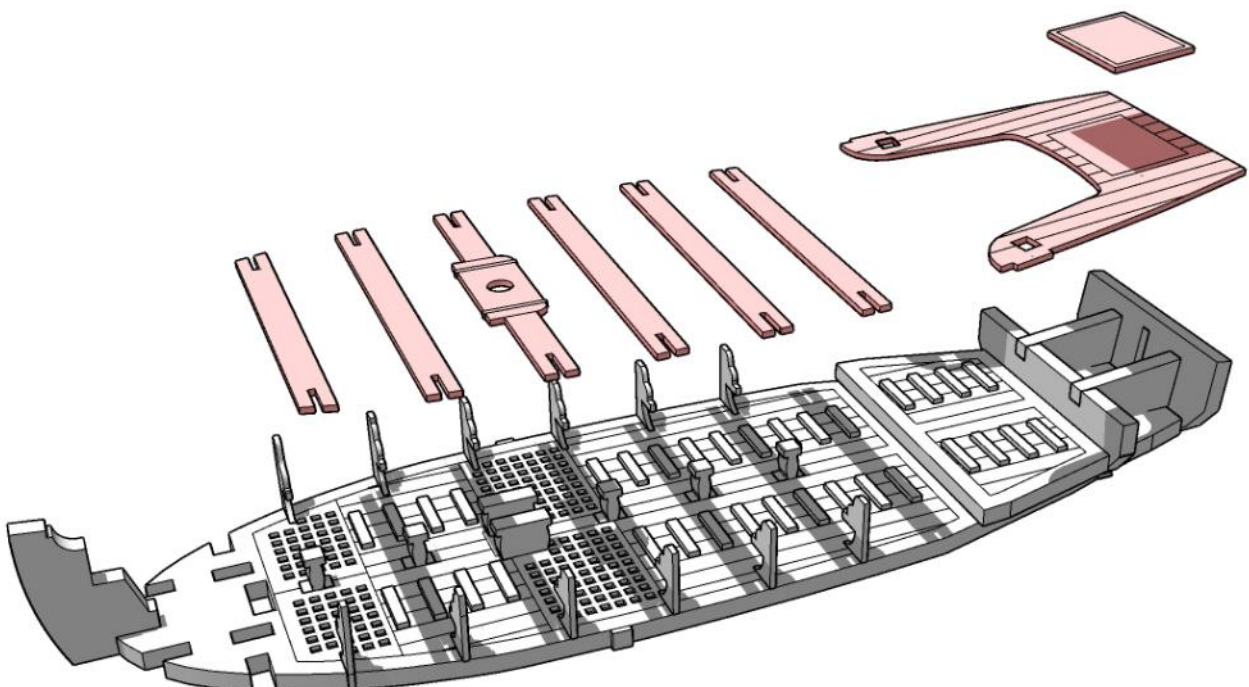

MINIATURE SCENERY

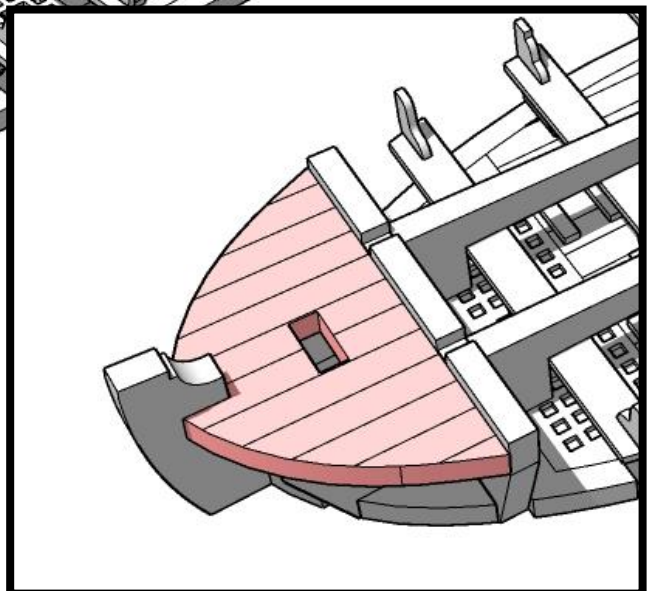
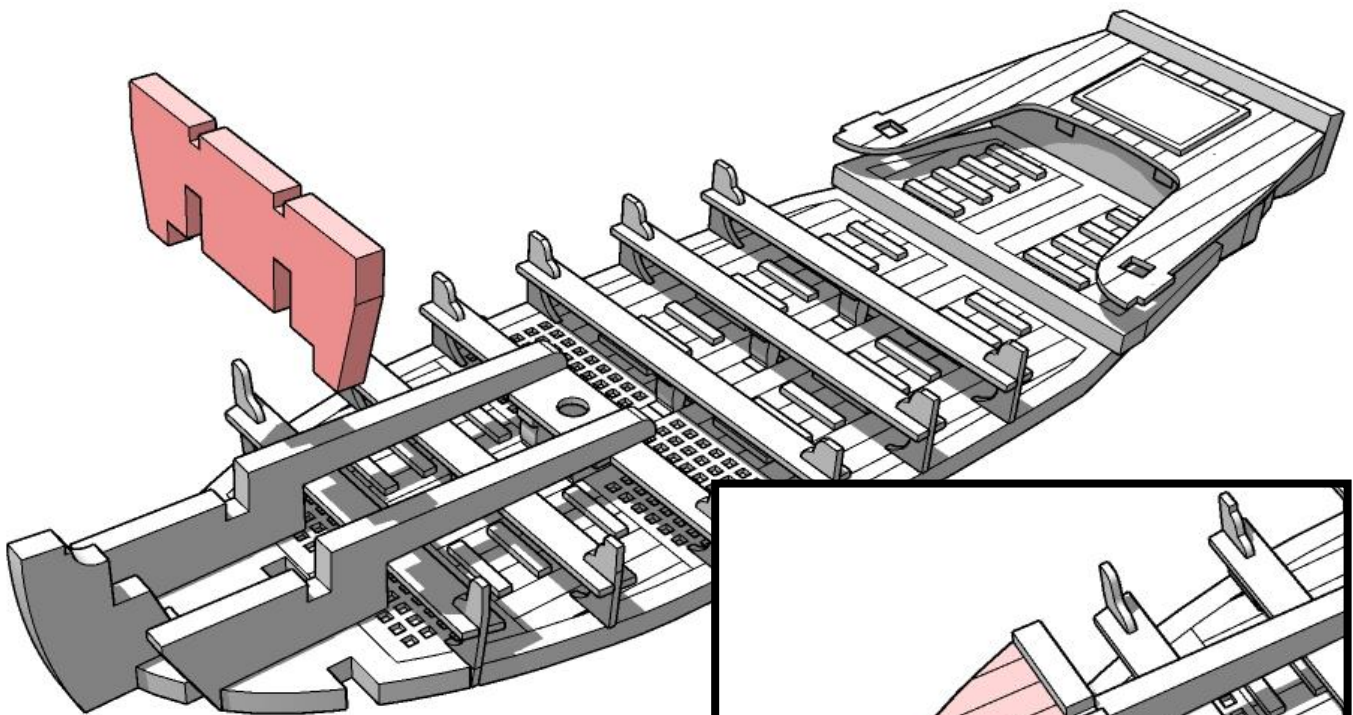
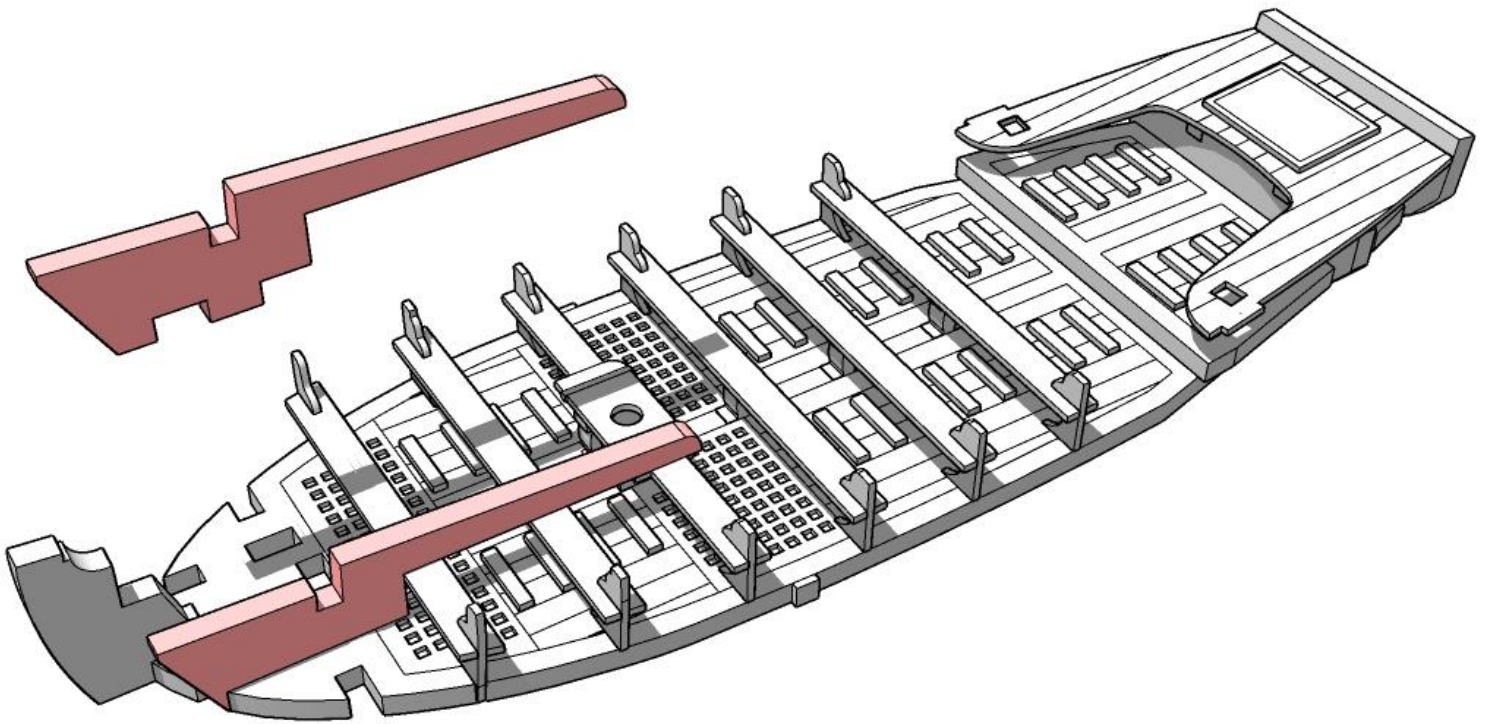

MINIATURE SCENERY

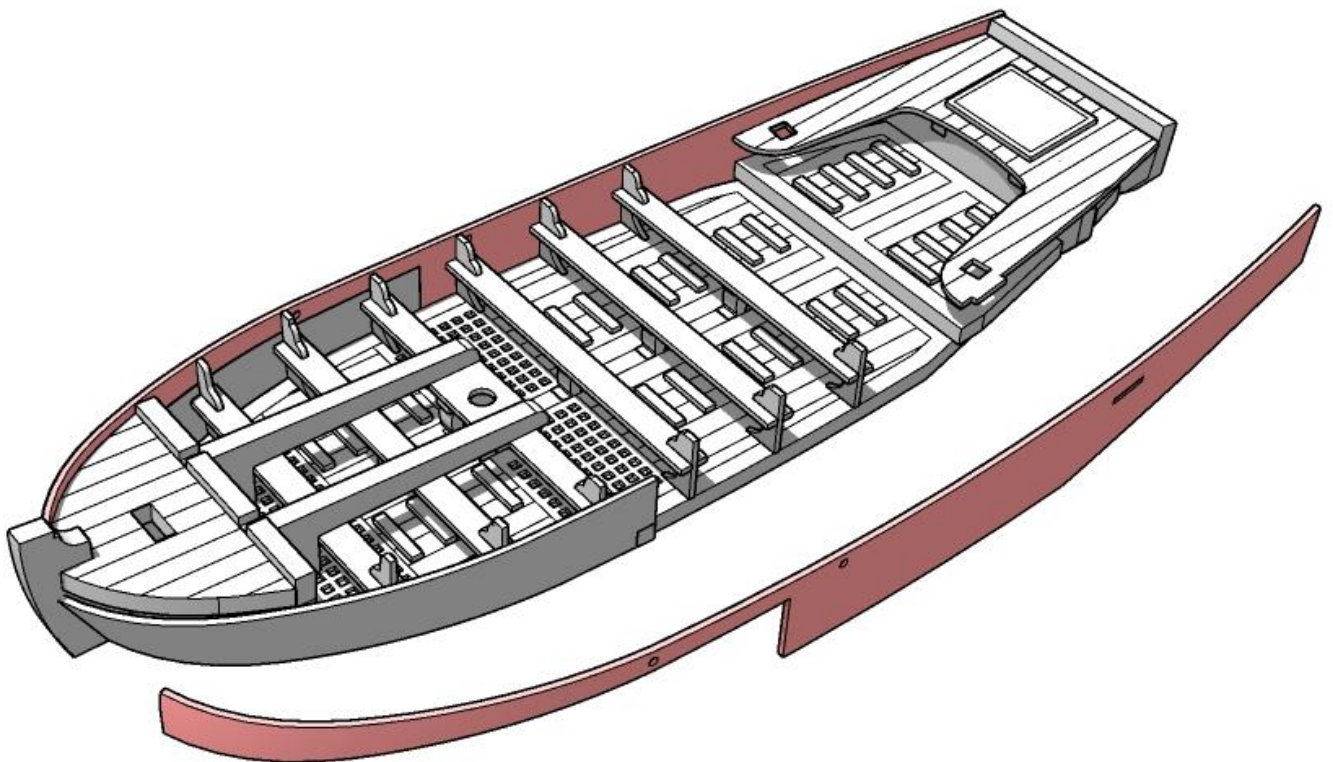
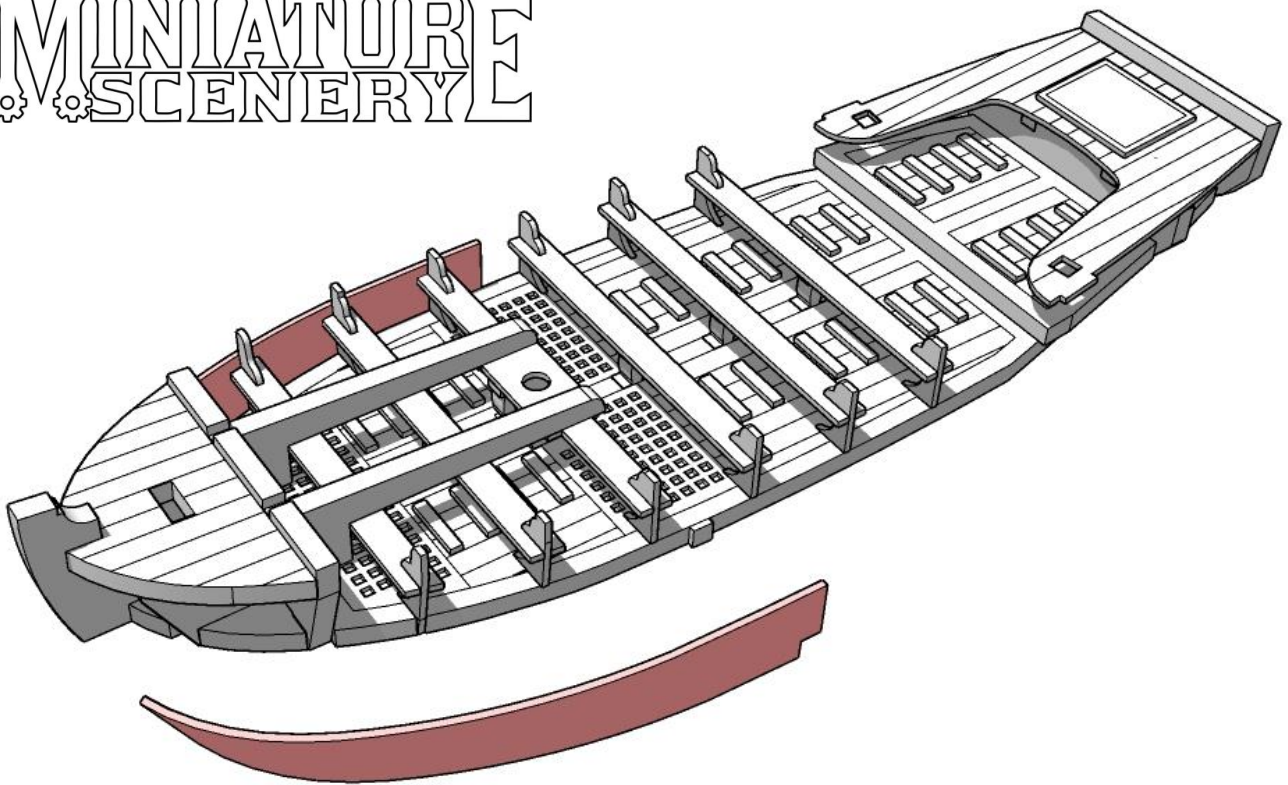

A few notes about the outer Skins:

- 1. Test fit the pieces (without glue) to familiarise yourself with their locations.**
- 2. It is far easier to pre-bend the shapes so they sit nicely in place before you glue.**
- 3. Allow each piece to THOROUGHLY dry before adding the next.**

And

- 4. The use of Rubber bands and/or small clips is recommended to keep them in place while drying.**

Be patient. Work on some other small assemblies (like the masts or barrels) while you wait.

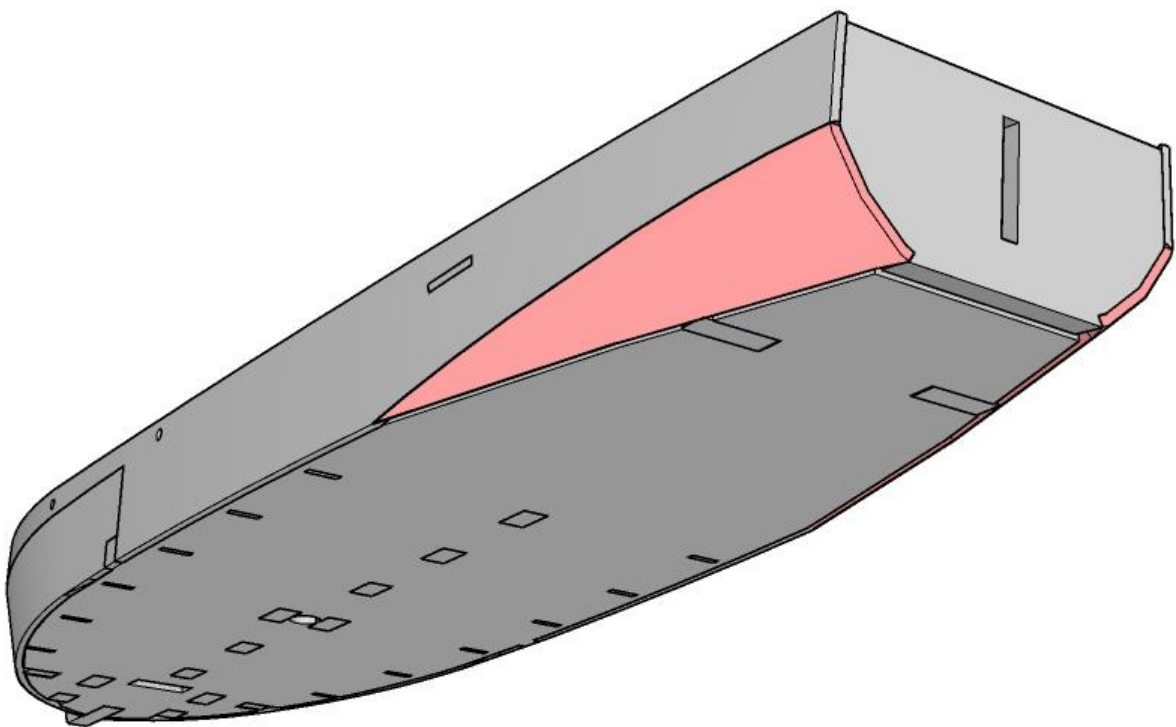

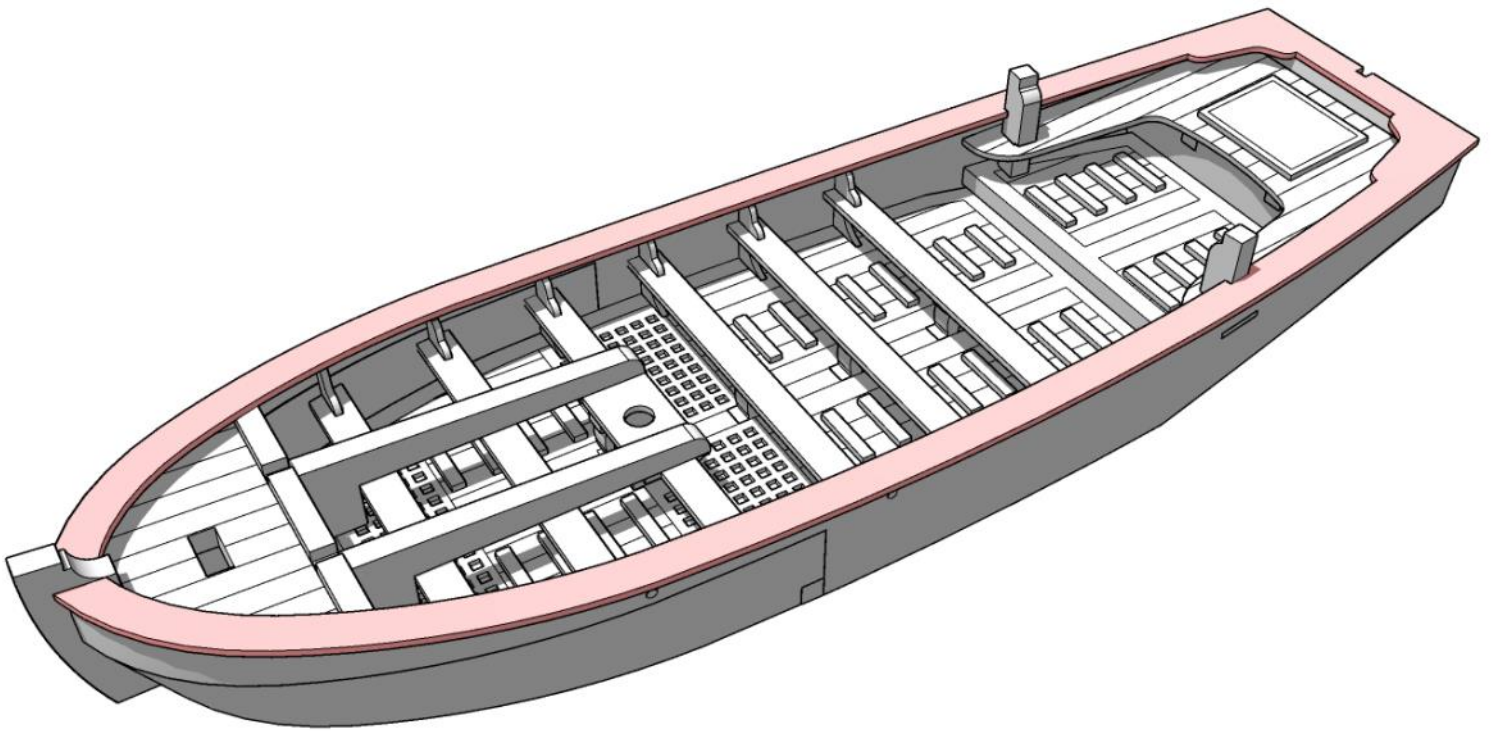
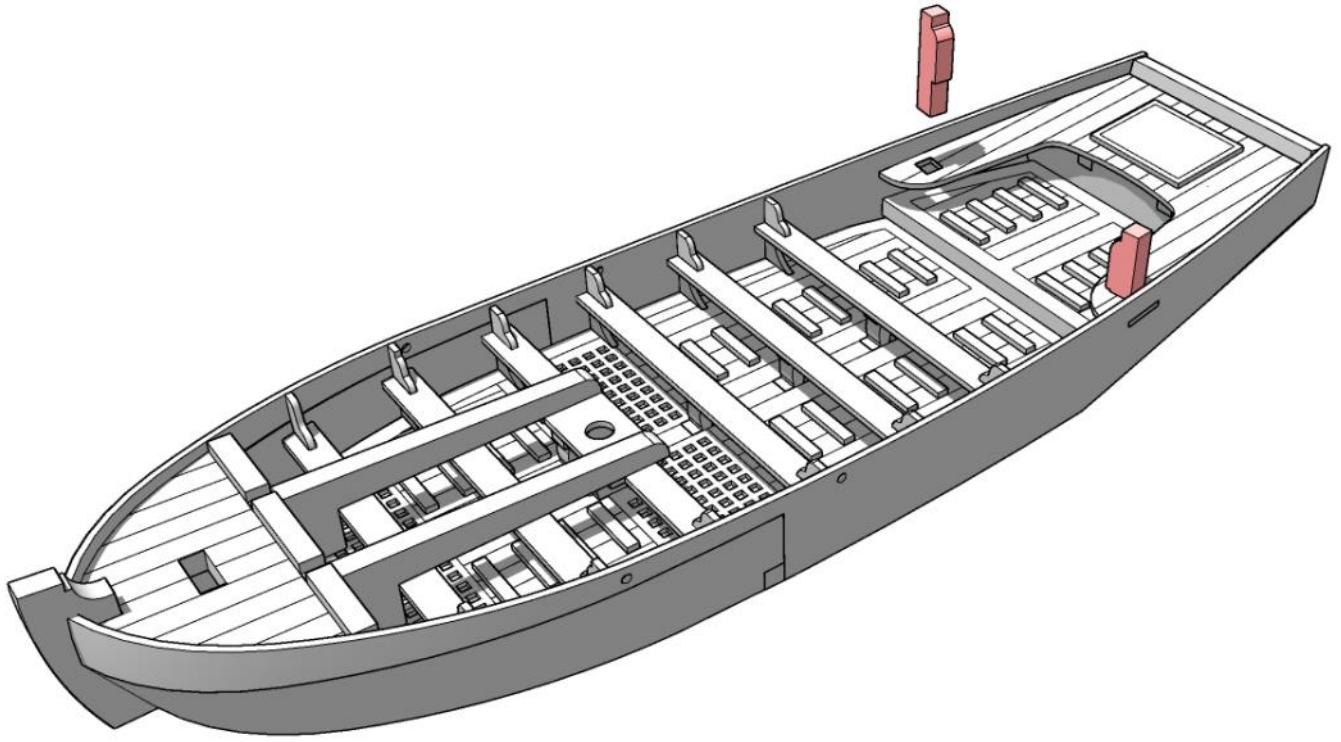

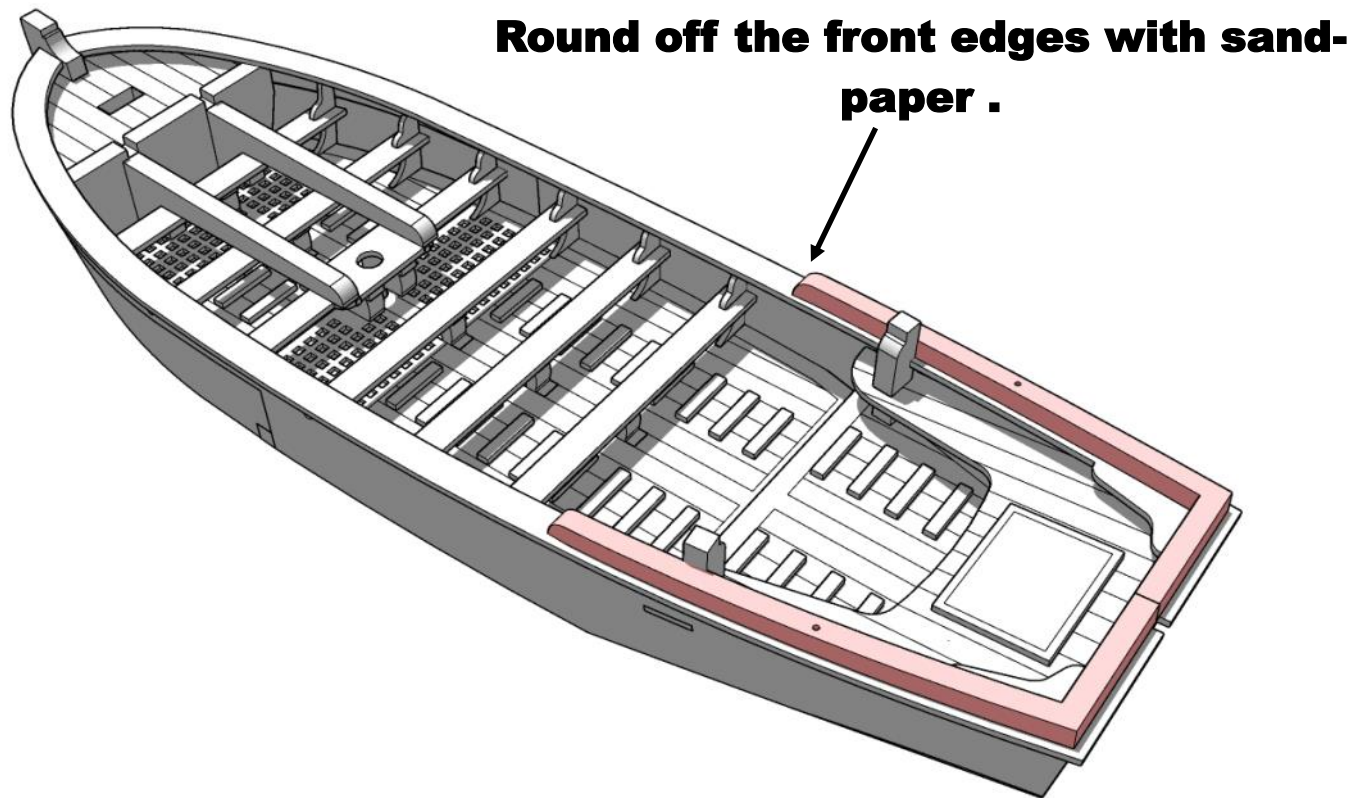

There is supposed to be a slight bend in this piece. You will need to hold it in place with a rubber band or similar while it's drying.

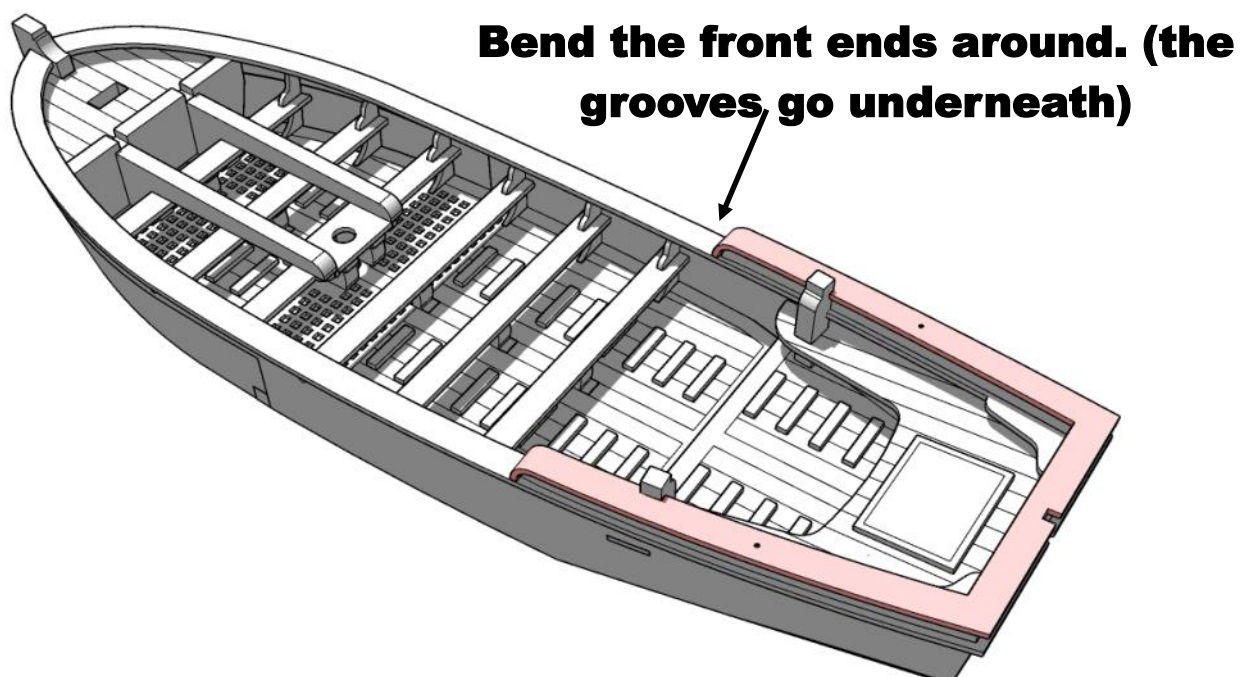
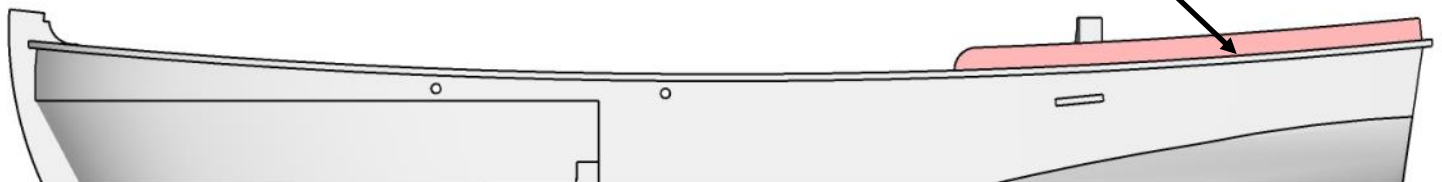

MINIATURE SCENERY

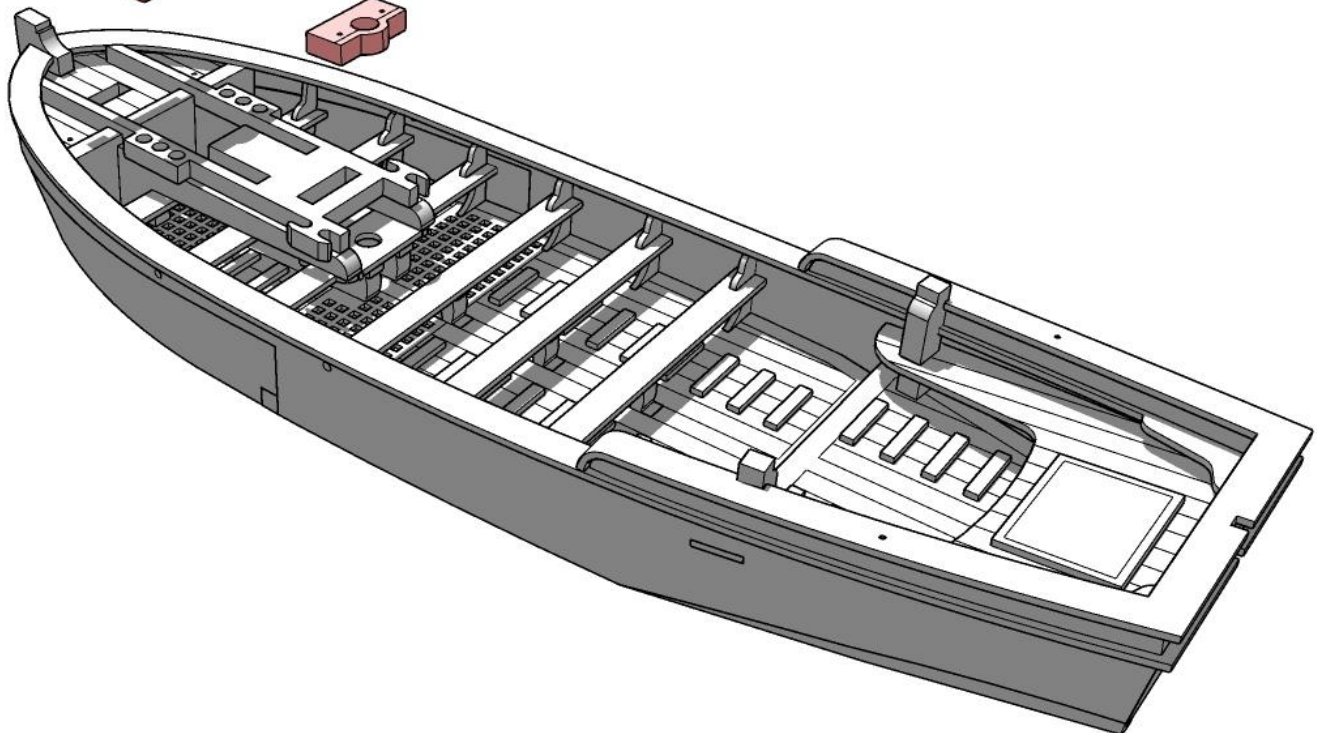
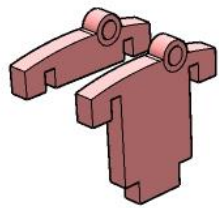
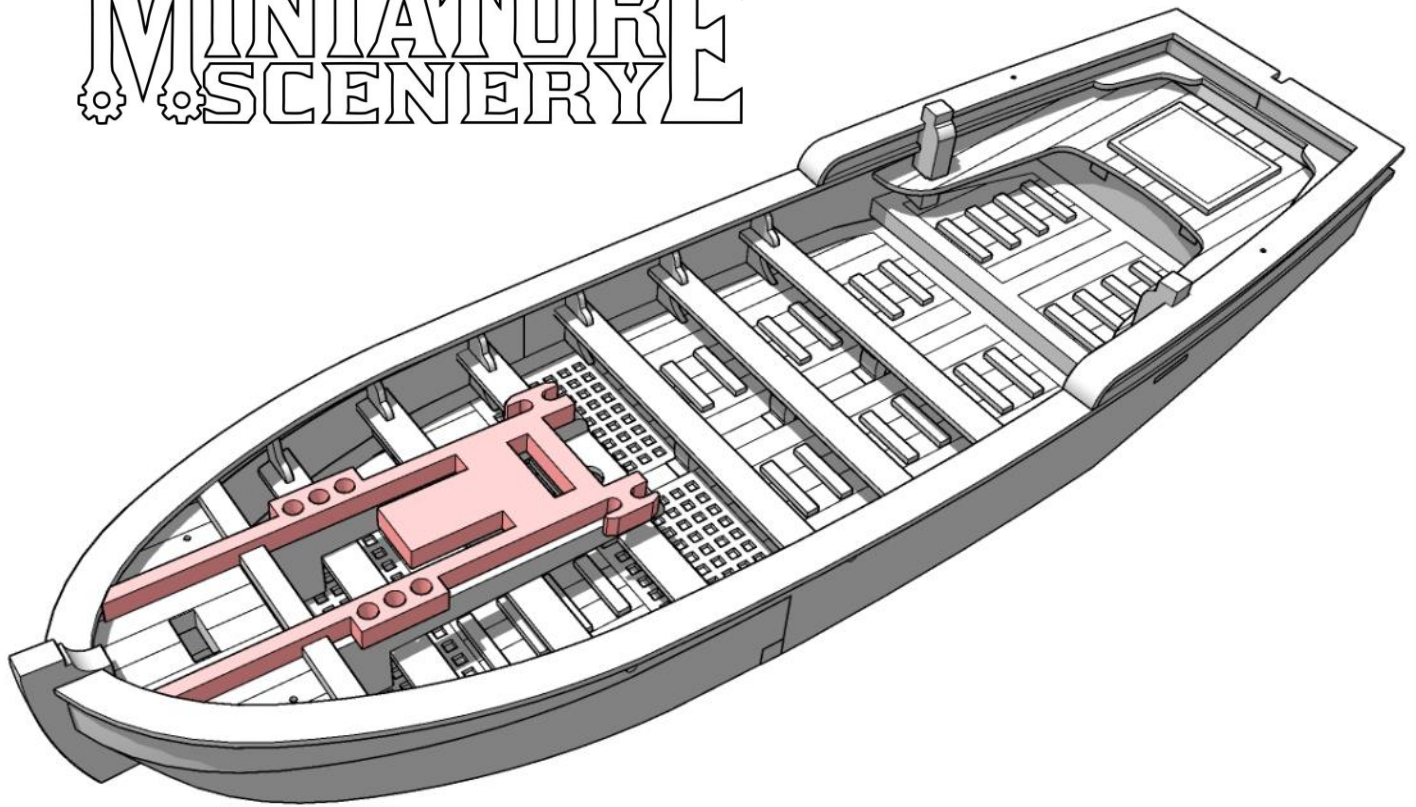

MINIATURE SCENERY

**Trim the included eye-bolts to length and
glue with a spot of superglue.**

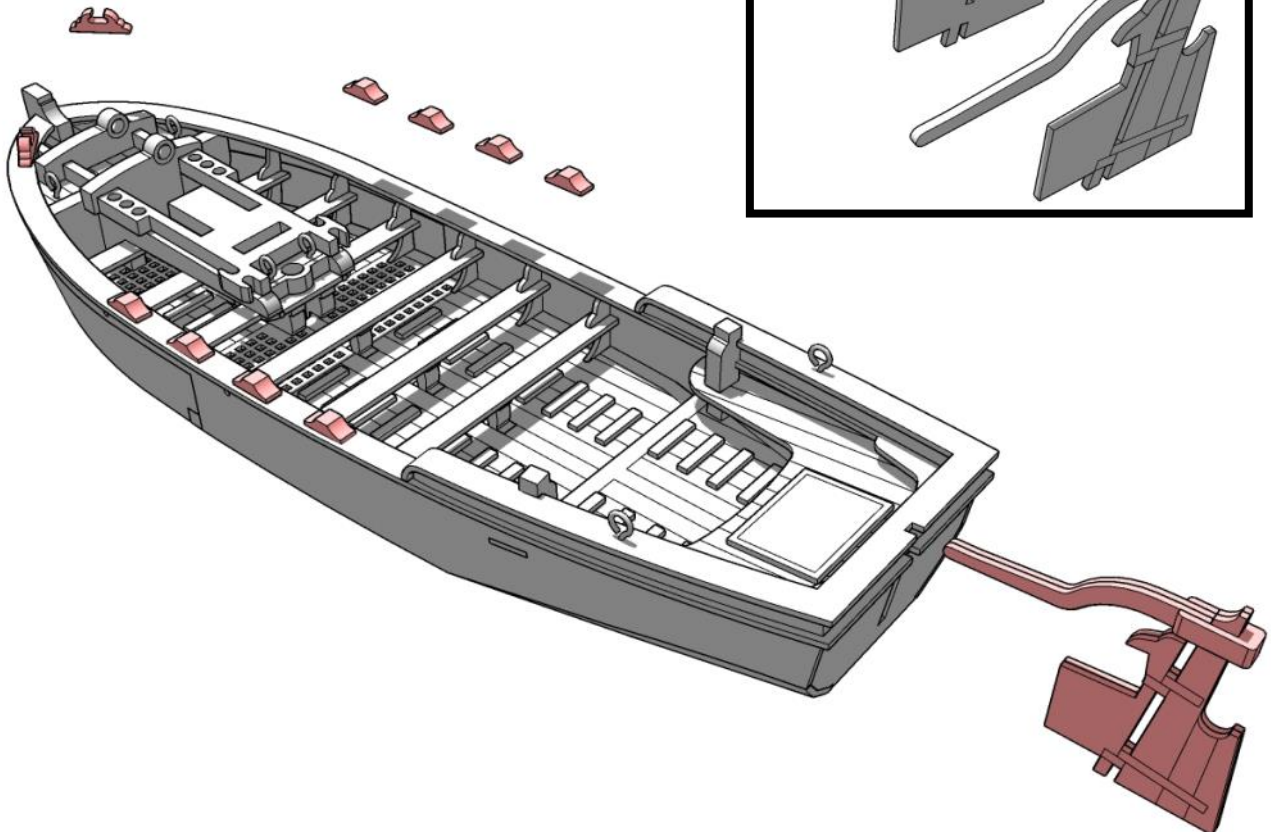
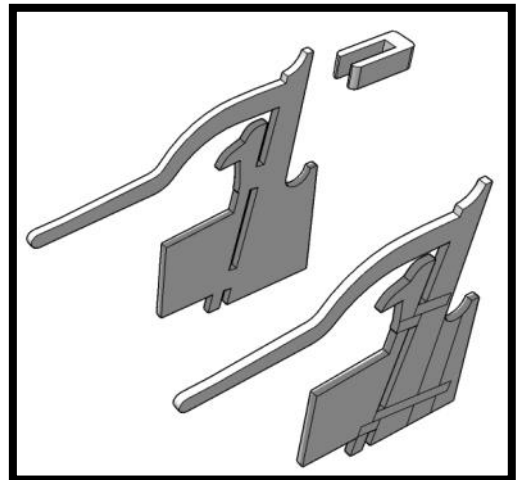
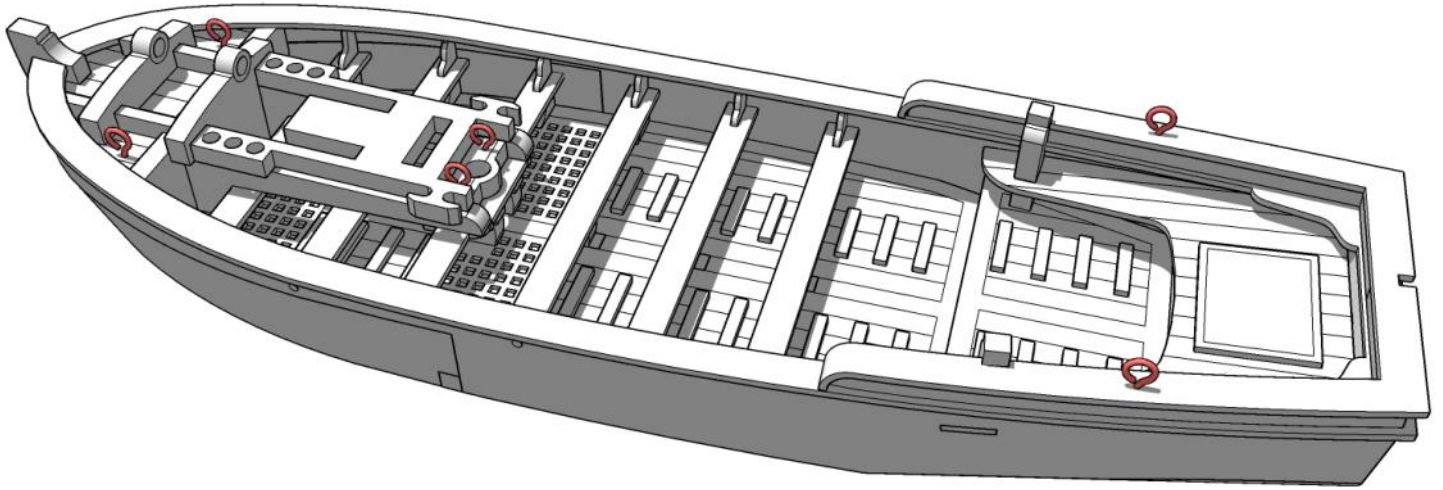

MINIATURE SCENERY

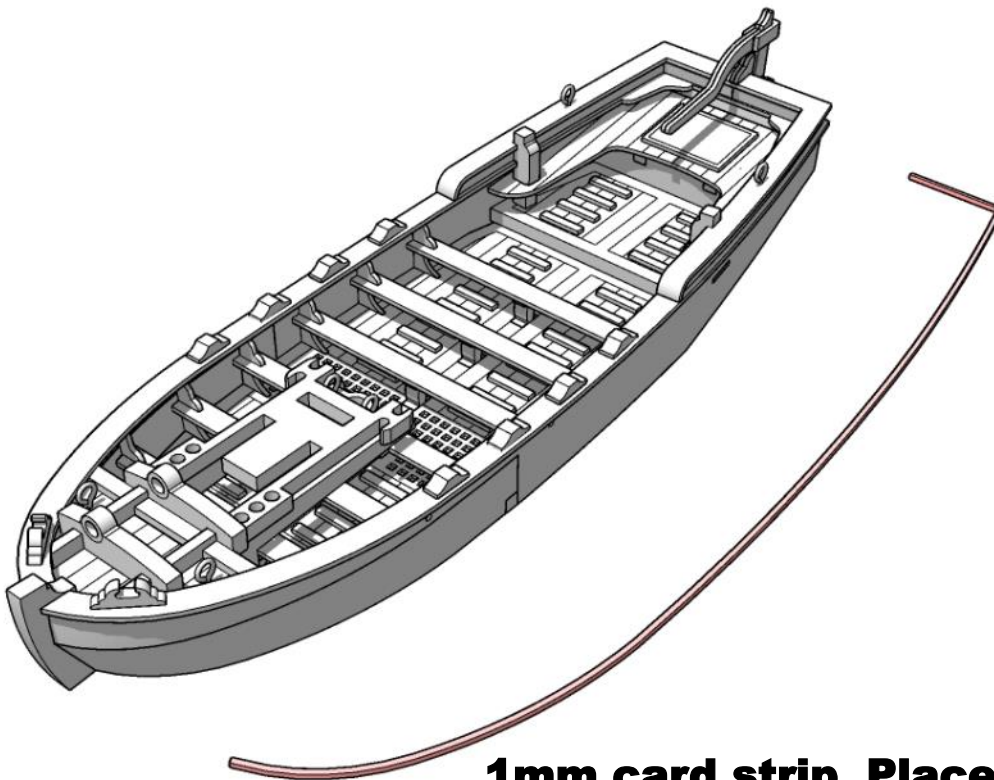
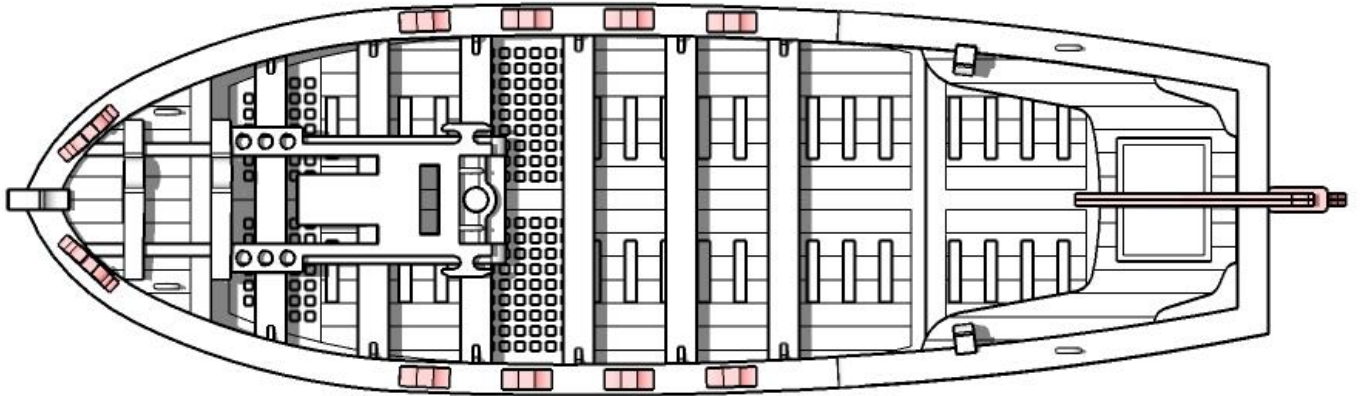

1mm card strip. Place this 3mm below the top edge. (you can use some scrap material to help you space it correctly).

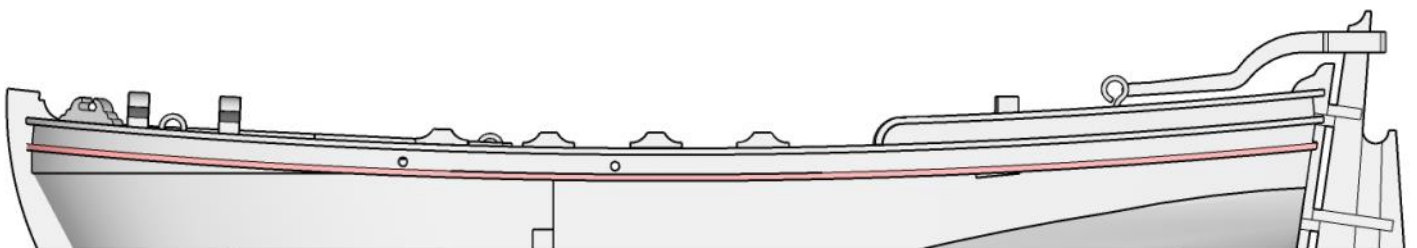

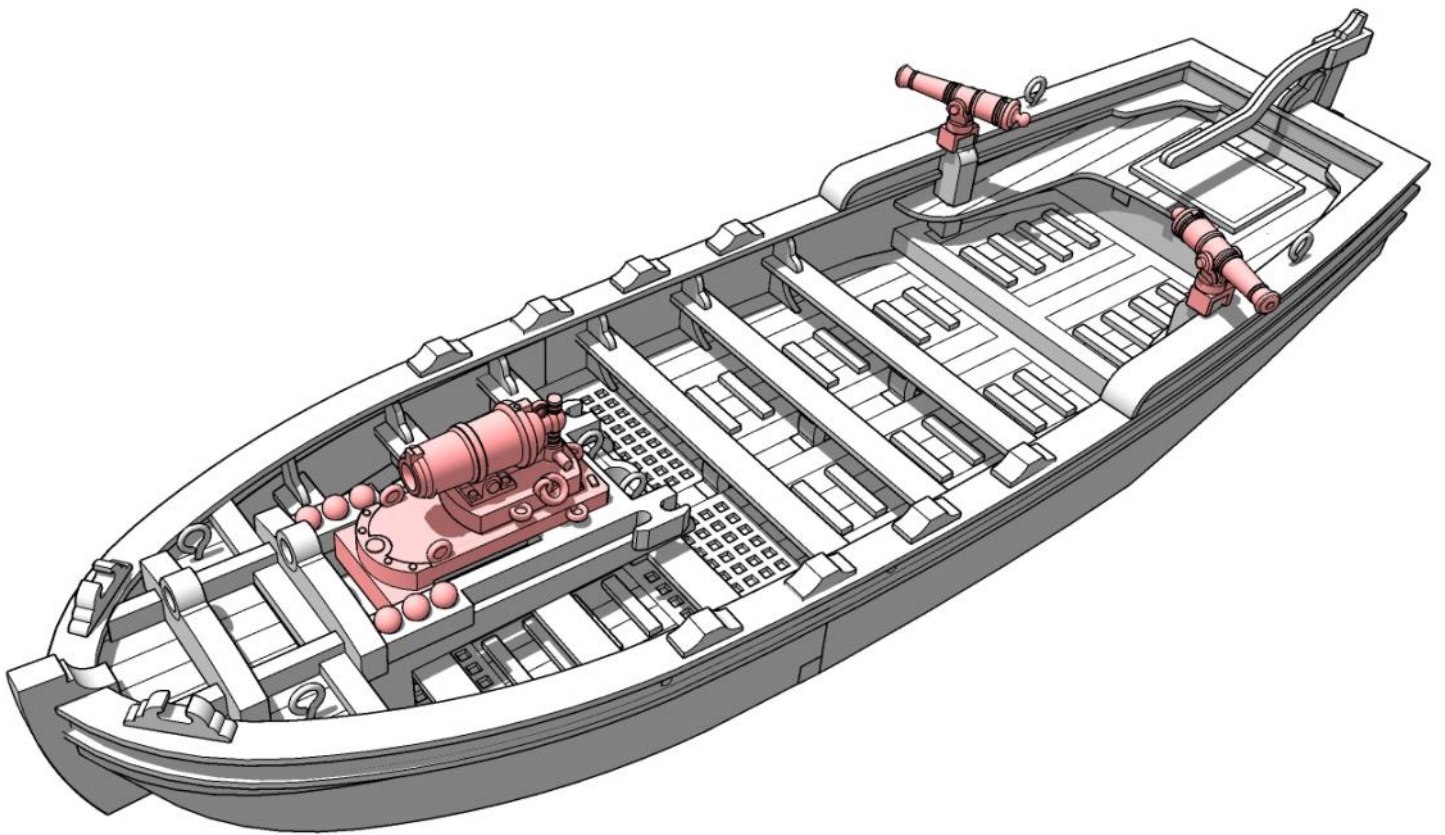
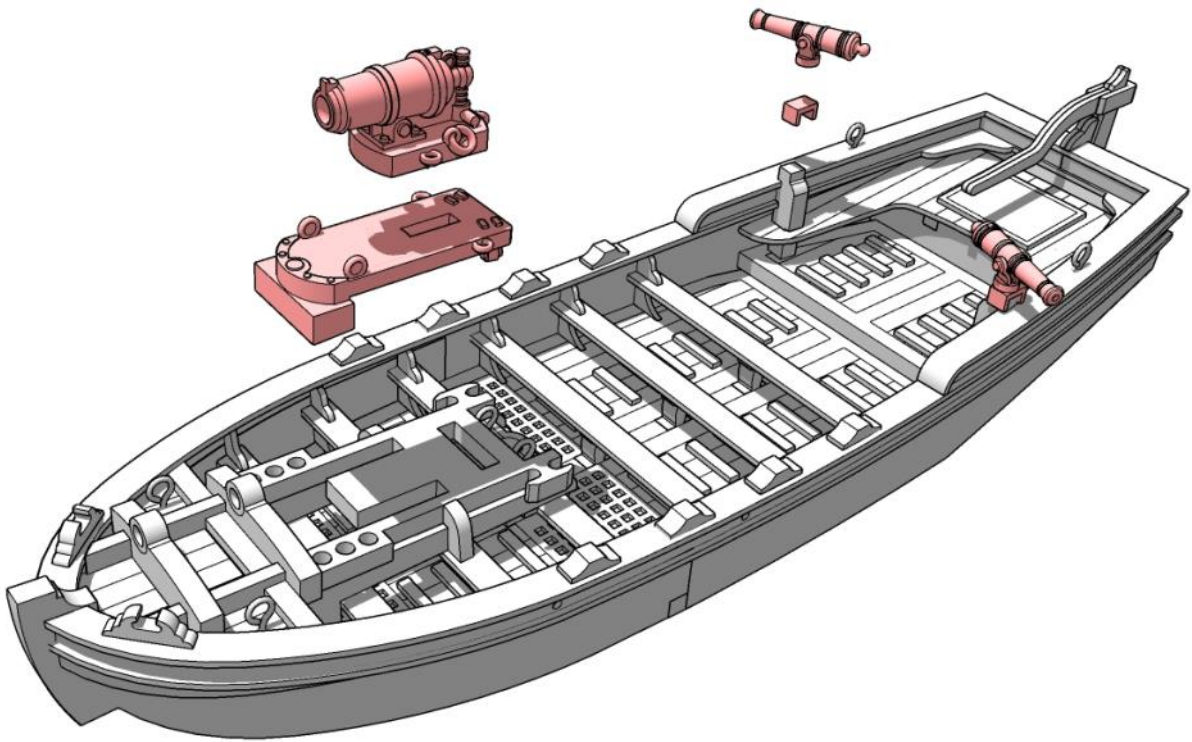

MINIATURE SCENERY

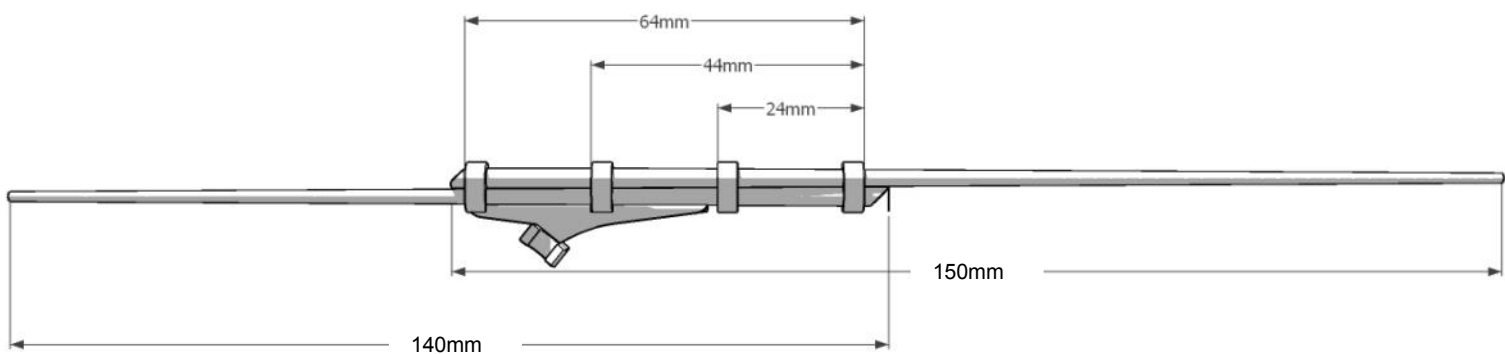
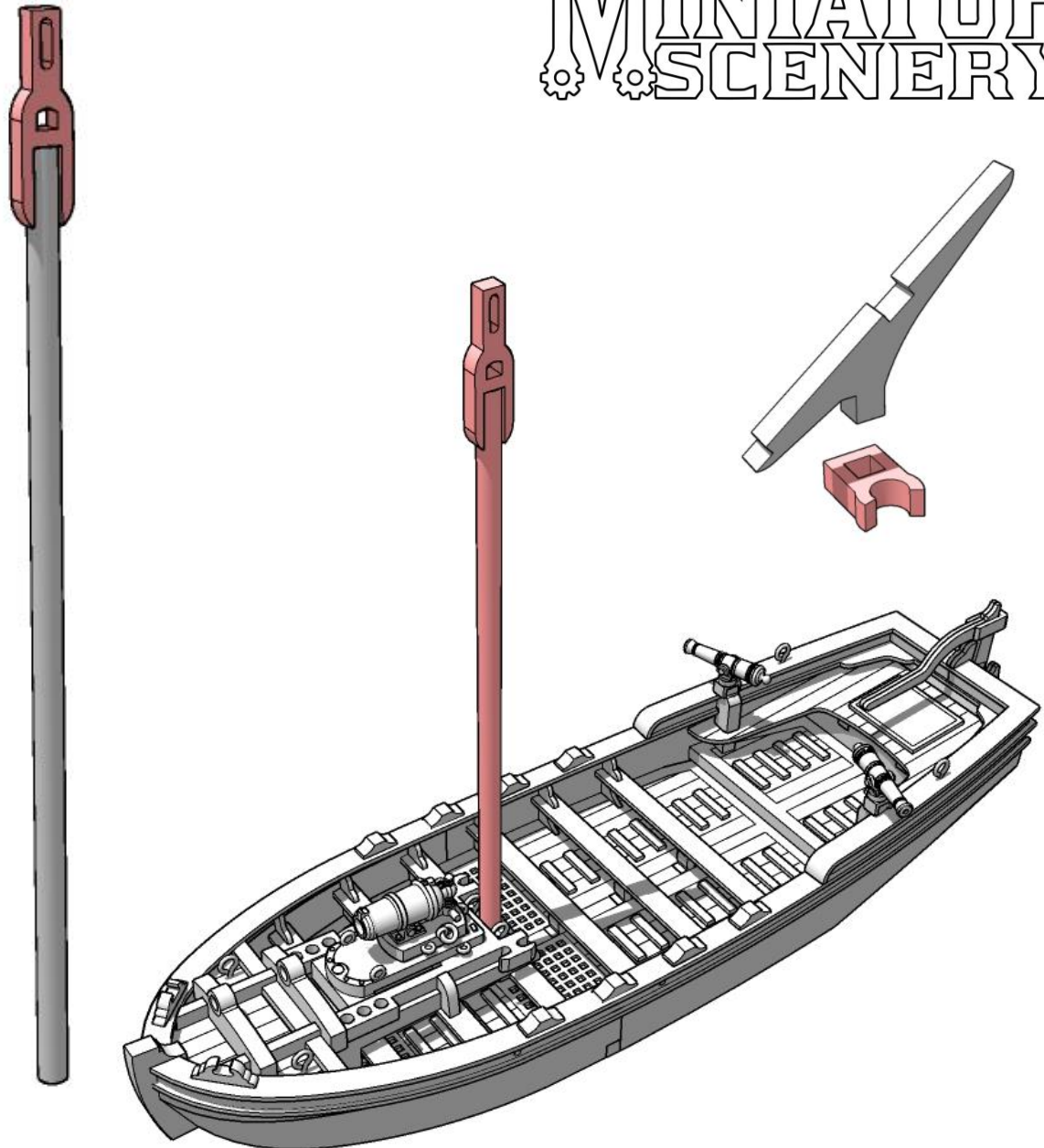

3mm Dowel Cut to length. Tapering the ends with some sandpaper and a bit of patience will improve the look of your model, but is not required.

Cut the ends at a 45 degree angle.

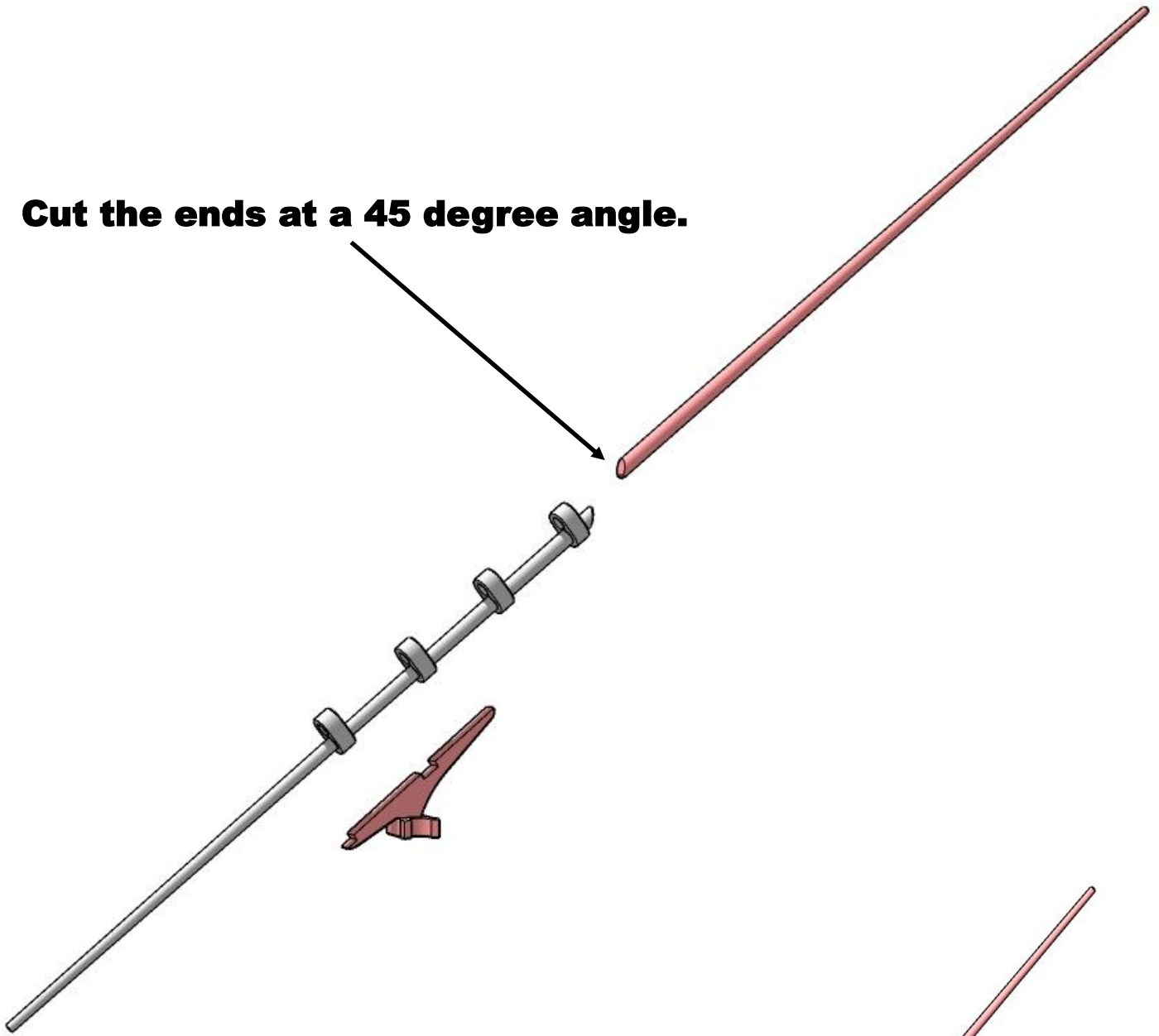

100mm length of 3mm dowel.

Note also the cover picture may show the Bowsprit mounted on the opposite side of the boat. This was an error on my behalf.

Apologies.

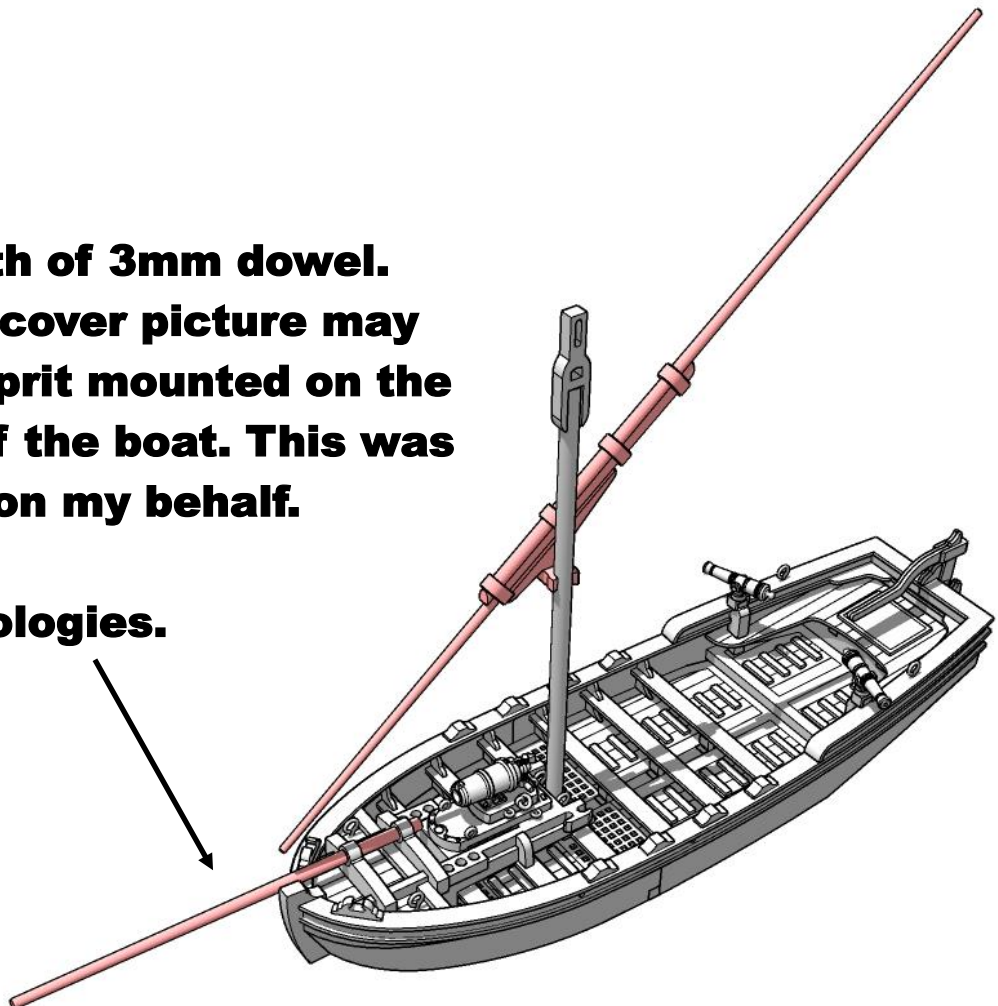

**Use the supplied elastic for the
Simplified Rigging as shown.**

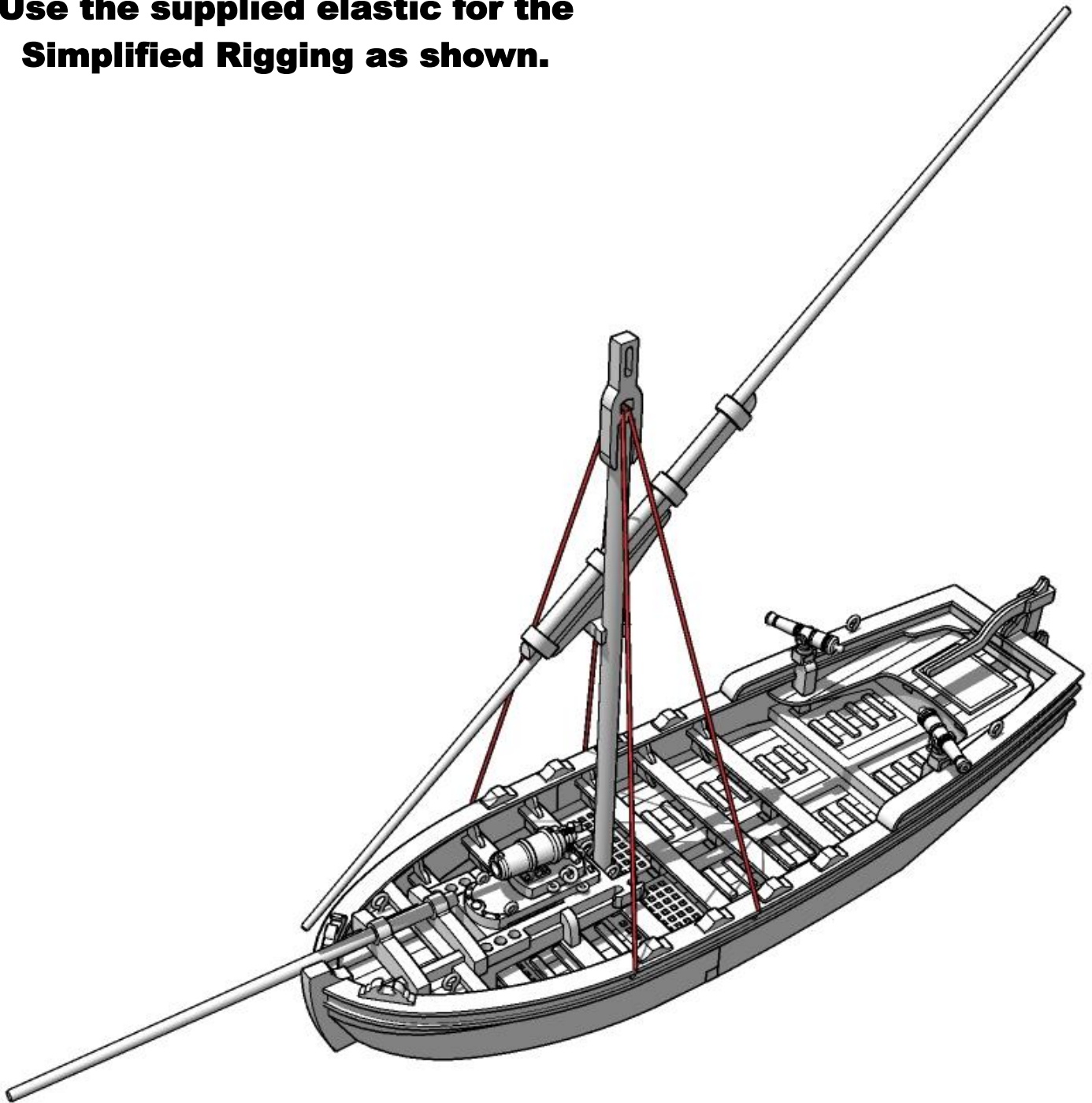

**Normal every day cotton can be used for the
smaller rope parts as shown on the cover of
the kit.**

**Cotton has not been included in the kit as it
is optional.**

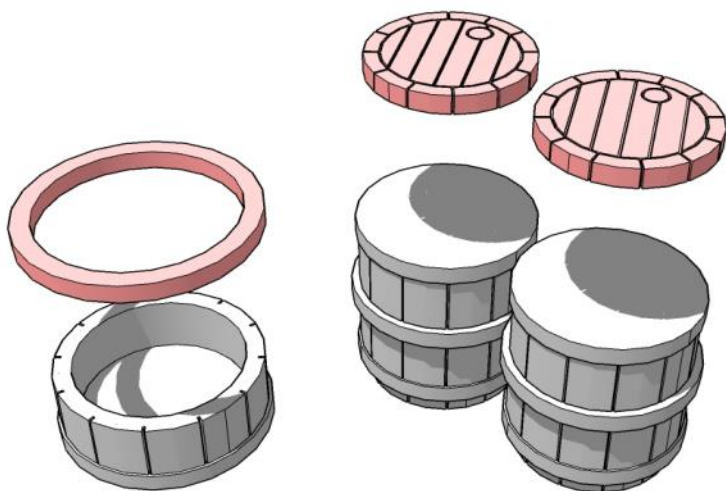
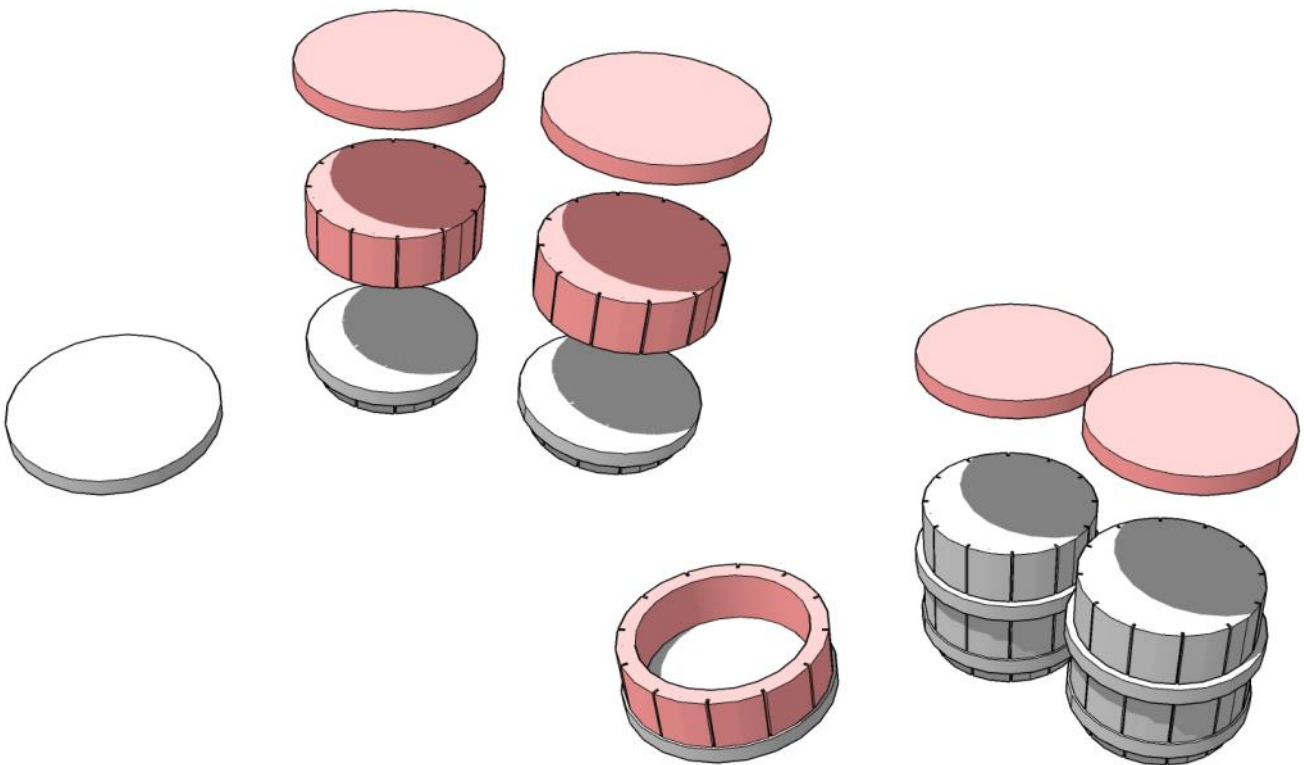
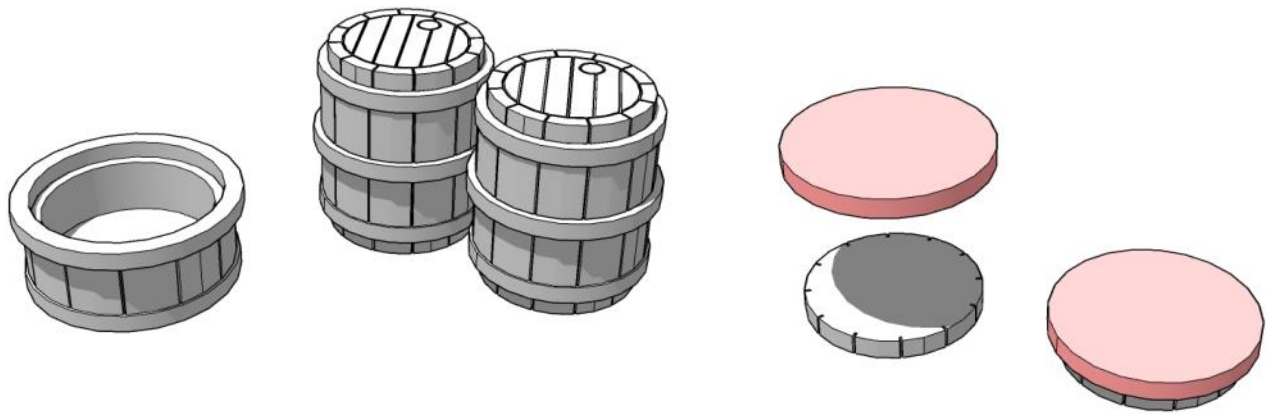

Note Slightly larger circle in middle

