

MINIATURE SCENERY

HEAVY HUMPT1 DUMPY TRUCK MK2



MINIATURE SCENERY IS DESIGNED FOR 28MM MINIATURES,
IDEAL FOR GAMERS AND COLLECTORS



FOR DETAILED, EASY TO FOLLOW INSTRUCTIONS VISIT
WWW.MINIATURESCENERY.COM



2724479701227

Contents may contain small parts. Not suitable for children under 6 years old. The exclusive copyright on the model designs and components within this case is the property of Miniature Scenery, 2016. All rights reserved.

MINIATURE SCENERY

INSTRUCTIONS HEAVY MULTI-PURPOSE TRANSPORT 1 (HUMPT1) MK2

PREPARATION

You will need:

- Cutting mat or something to protect your table.
- PVA/Wood glue or superglue if you prefer.
- Small file or sand paper.
- Small blade / hobby knife



GENERAL PROCESS

- Clear plenty of table space, you will need it.
- Parts should remove easily from the board by pressing through and popping them out. It's a good idea to cut through the tiny joins first though, and some parts (particularly smaller, more detailed parts) may need more careful persuasion.
- Use file or sand paper to remove the small burr caused by the connection to the frame.
- It's a good idea to familiarise yourself with how the pieces fit together before gluing.
- Slot the parts together as shown by the pictures below, applying glue wherever there is a connection. (unless shown otherwise)
- Parts may be a very tight fit, slight trimming or sanding of parts may be needed for ease of assembly.

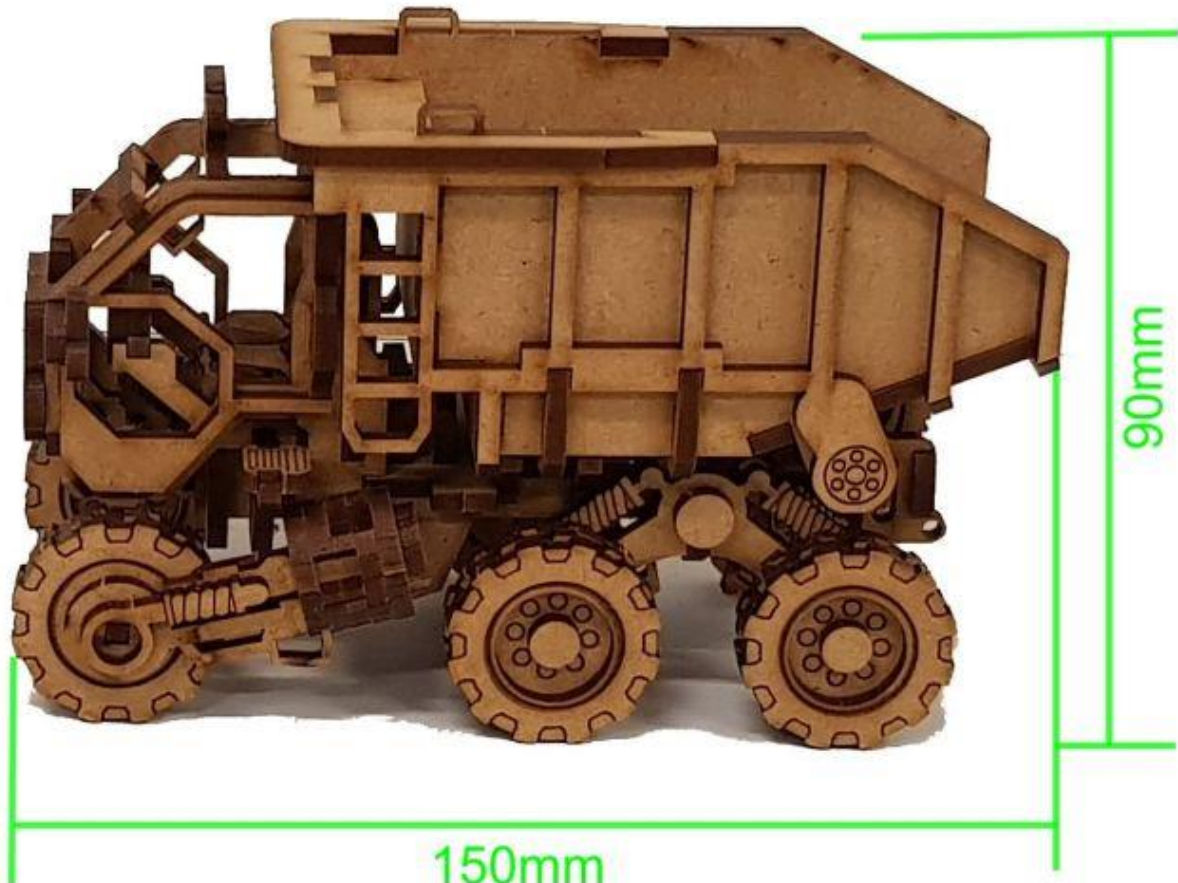

MINIATURE SCENERY

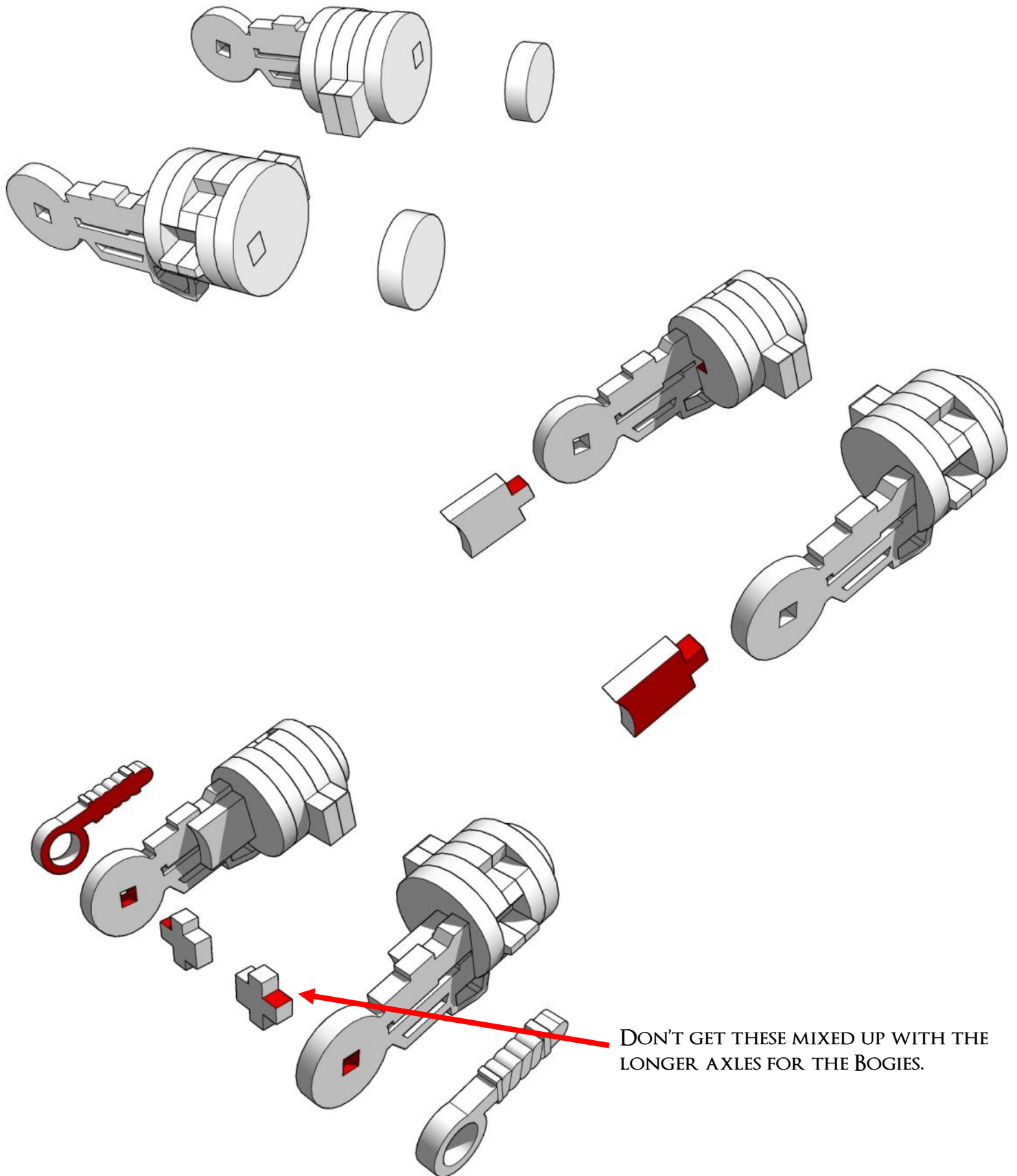

MINIATURE SCENERY

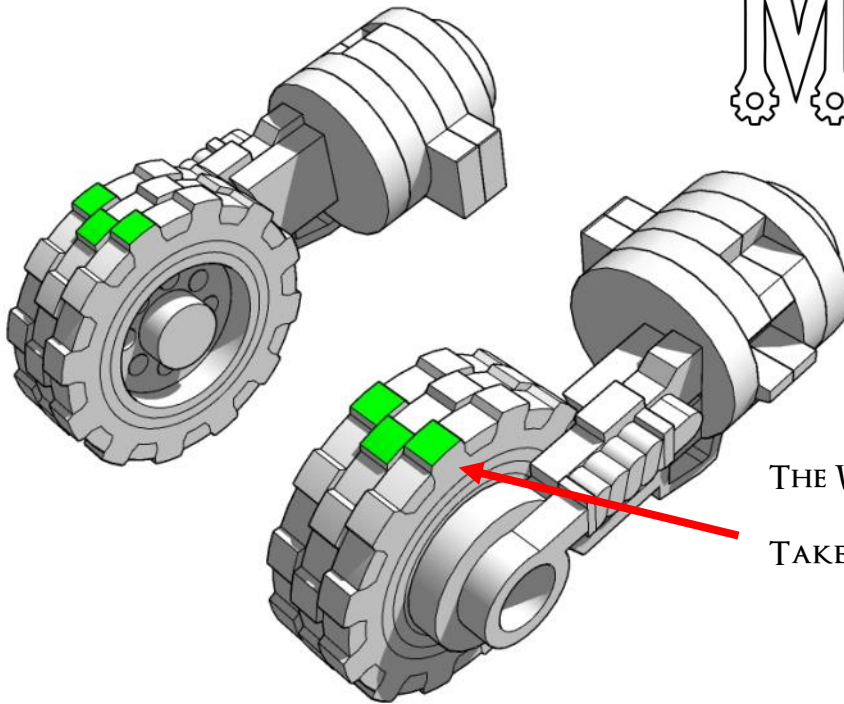

THE WHEELS IN THIS KIT ARE HANDED.

TAKE NOTE OF THE DIRECTION OF TREAD.

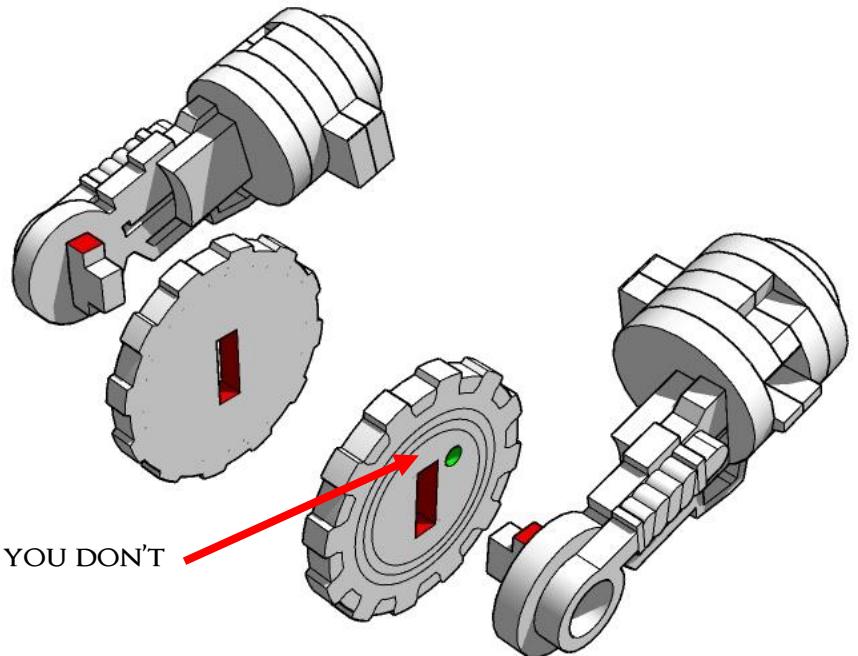

HOLE ON LEFT HAND SIDE SO YOU DON'T
GET THEM MIXED UP.

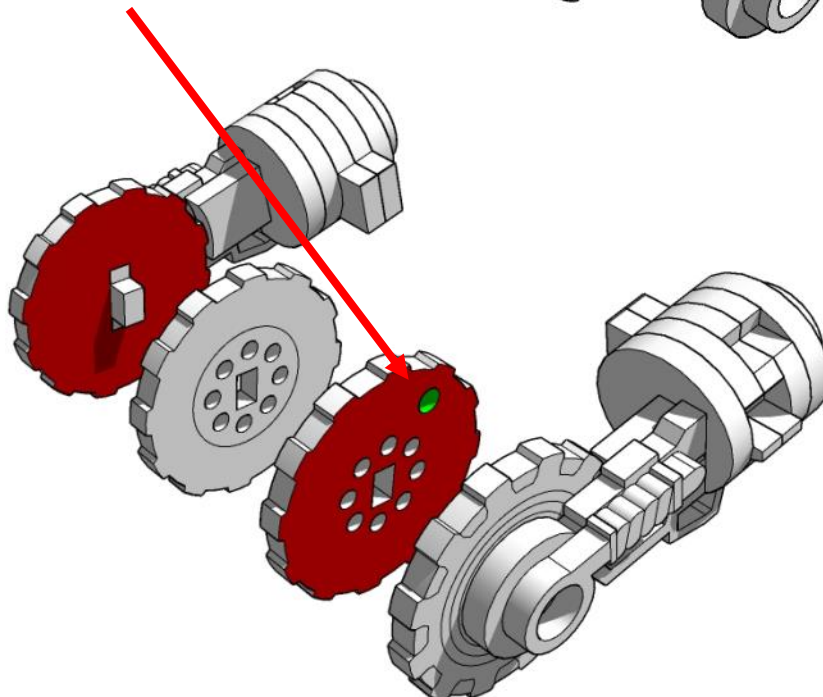

MINIATURE SCENERY

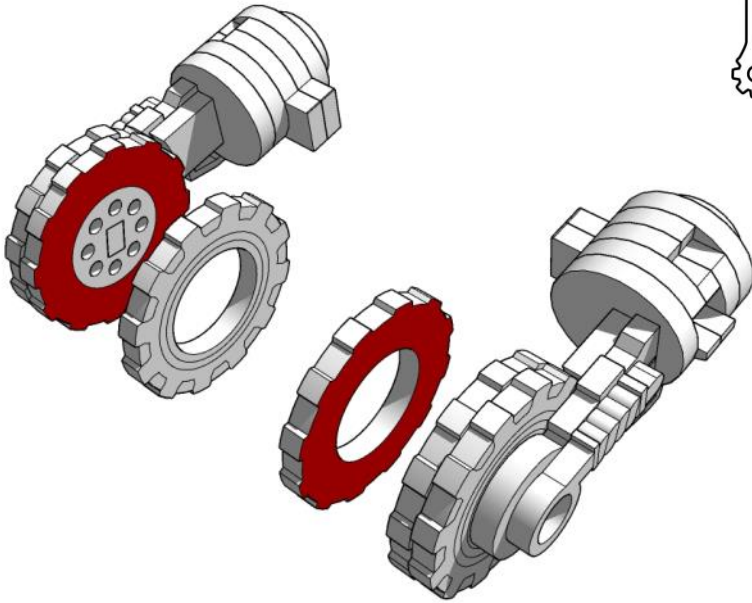

THE WHEELS FOR THE REAR BOGIES ARE ALSO HANDED, MAKE TWO OF EACH. THE WHEELS WITH THE HOLES WILL GO ON THE RIGHT HAND SIDE THIS TIME.

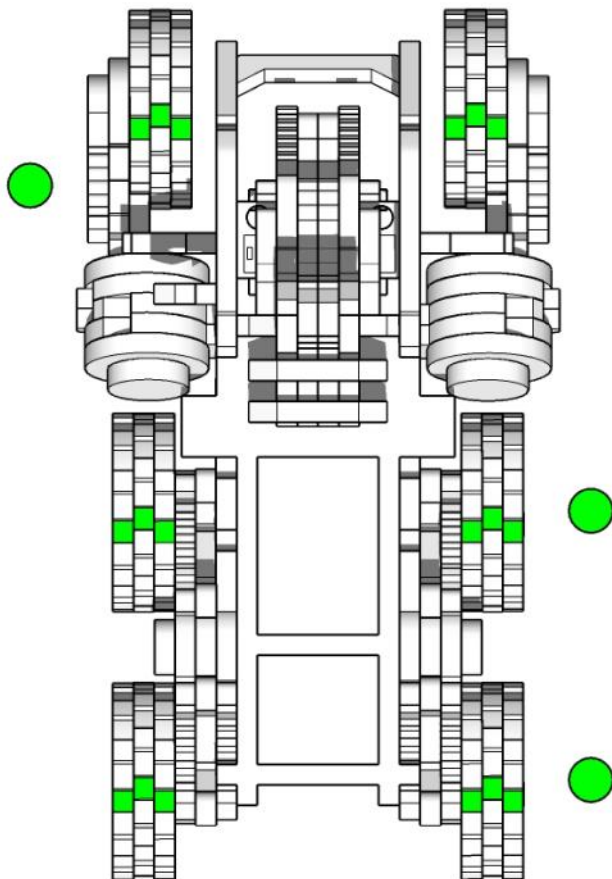
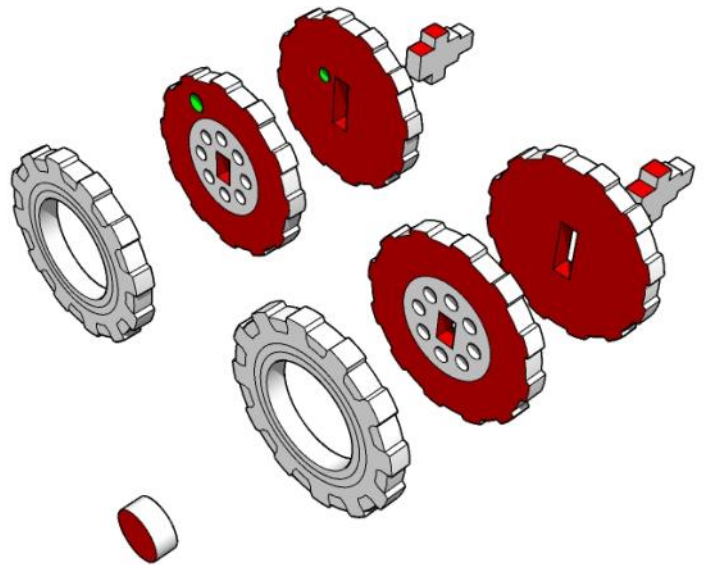

MINIATURE SCENERY

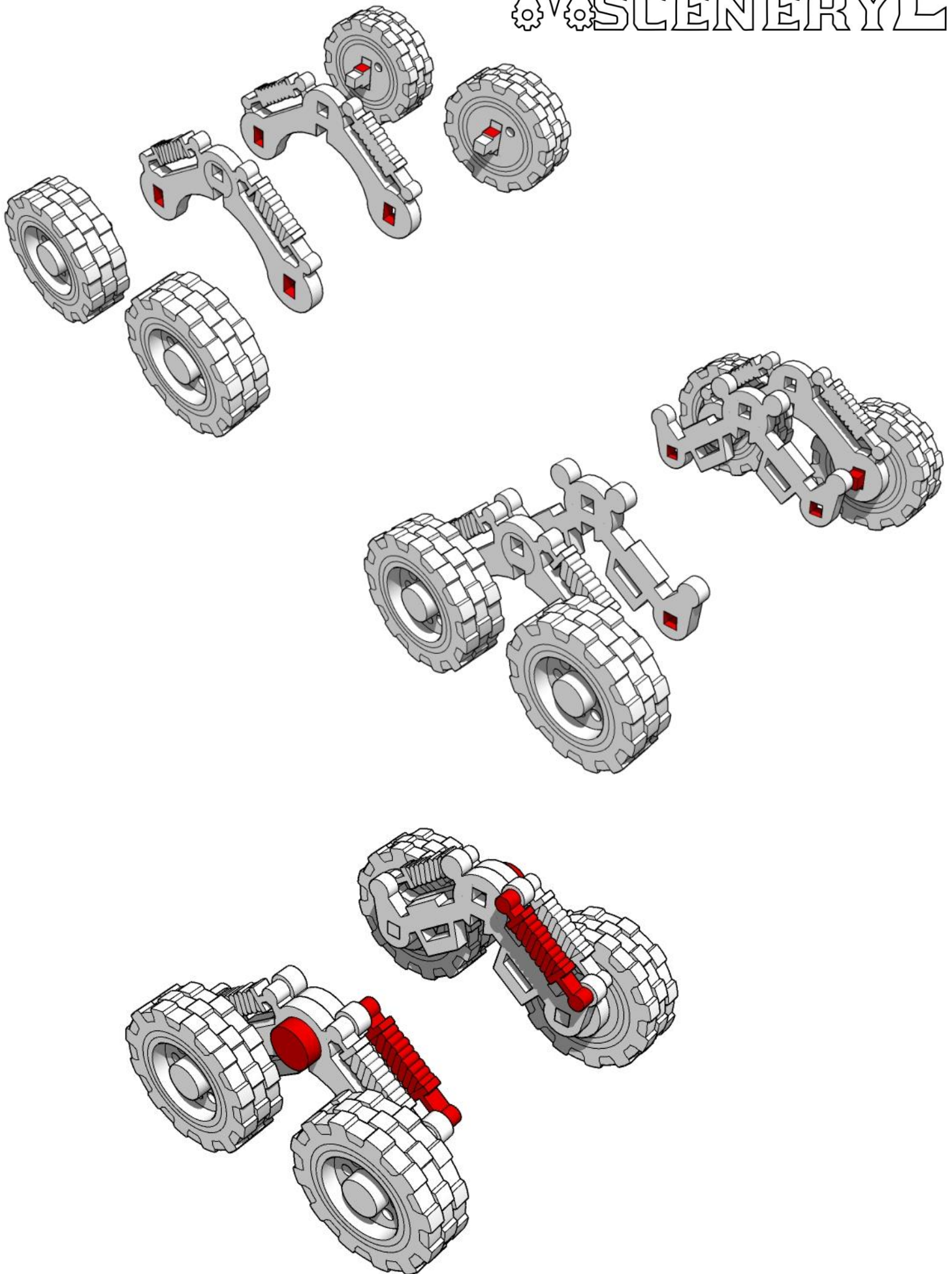

MINIATURE SCENERY

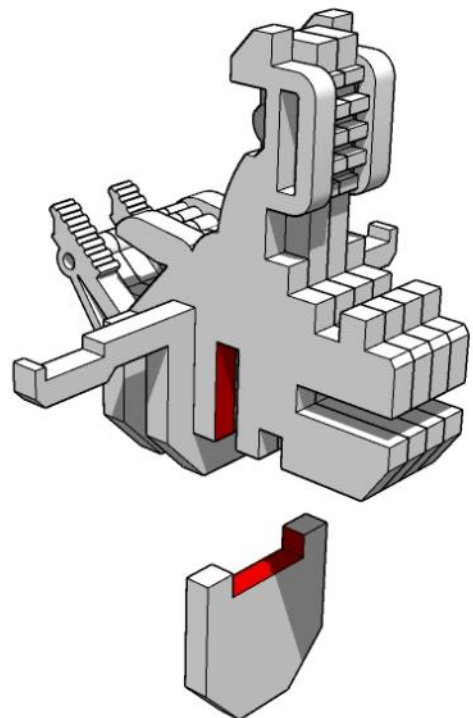
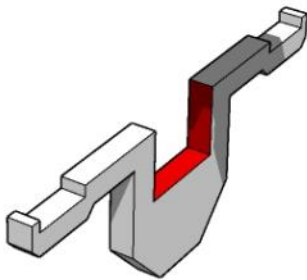
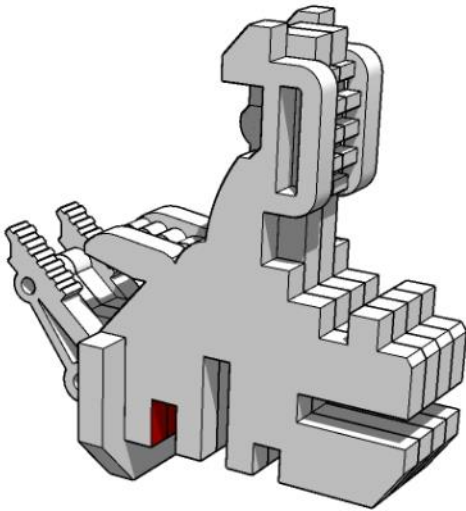
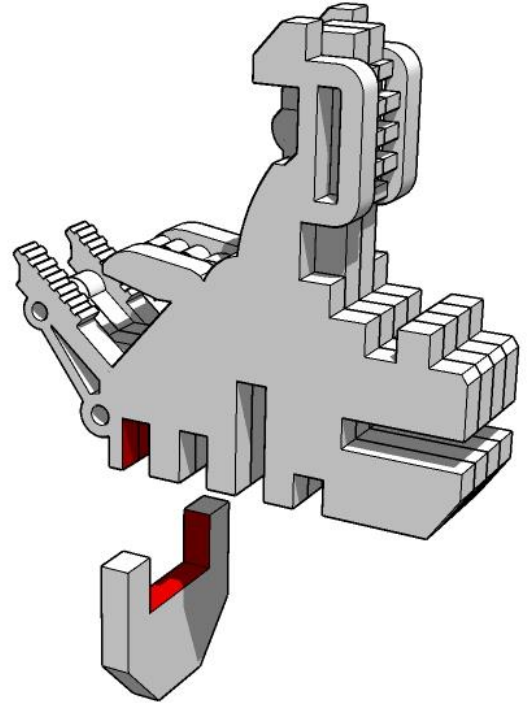
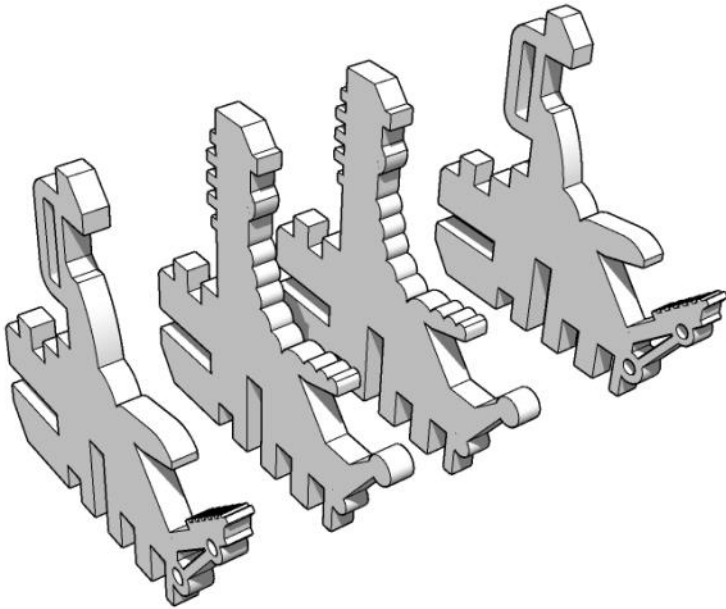

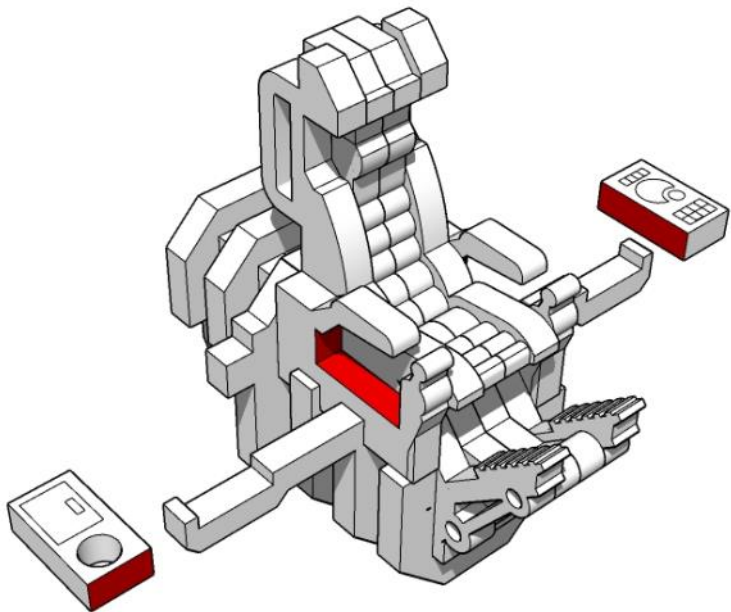
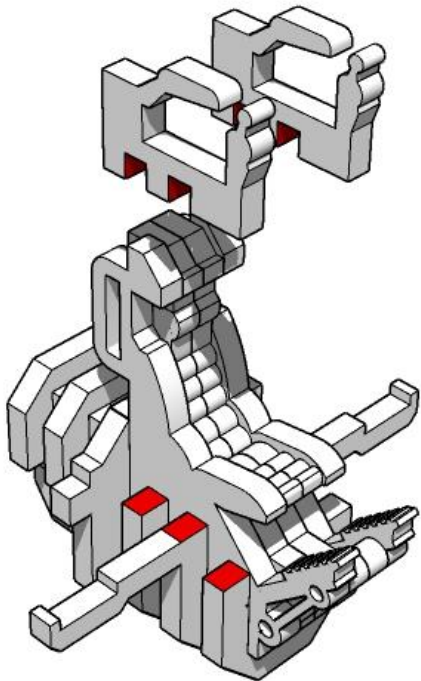
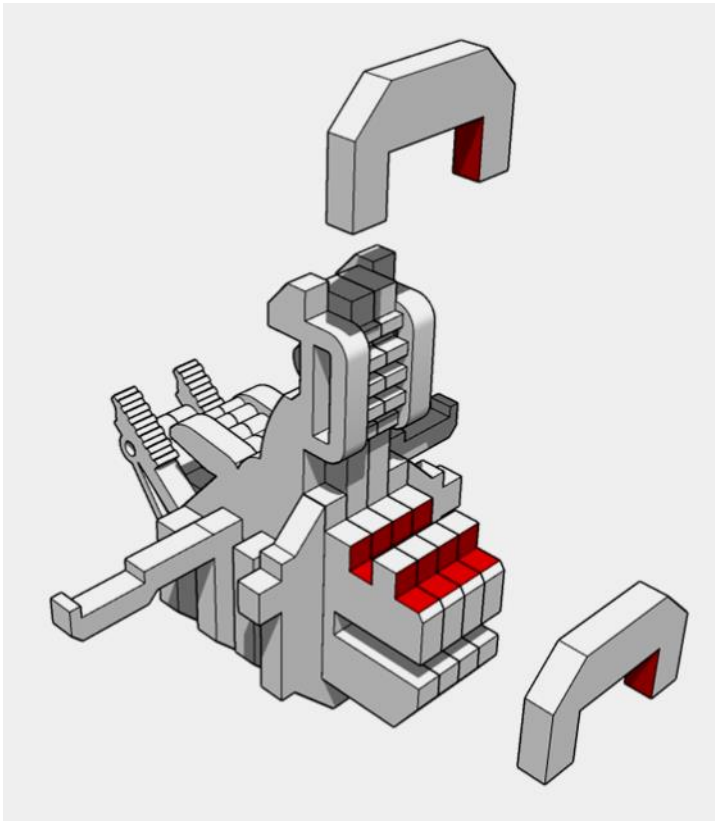
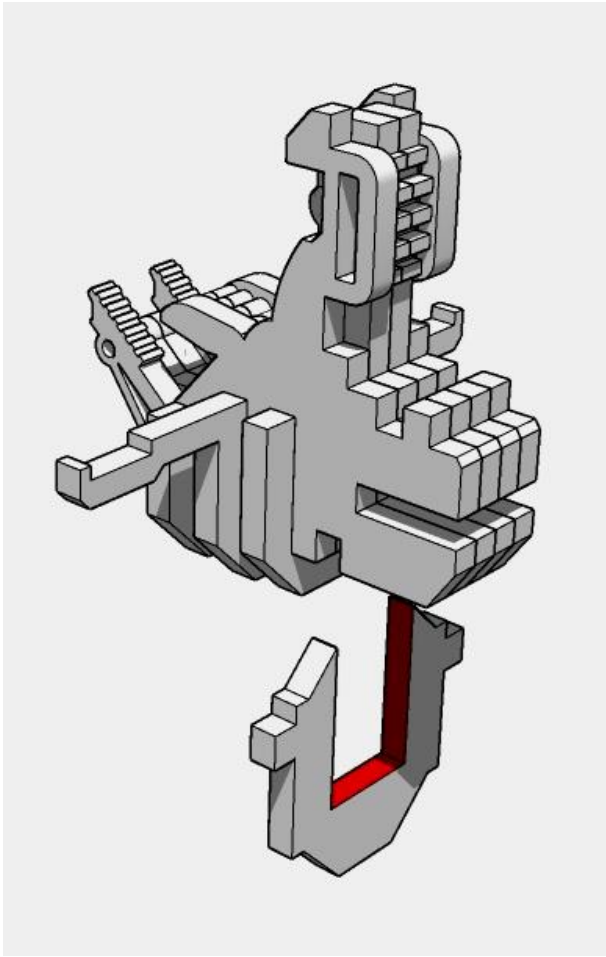

MINIATURE SCENERY

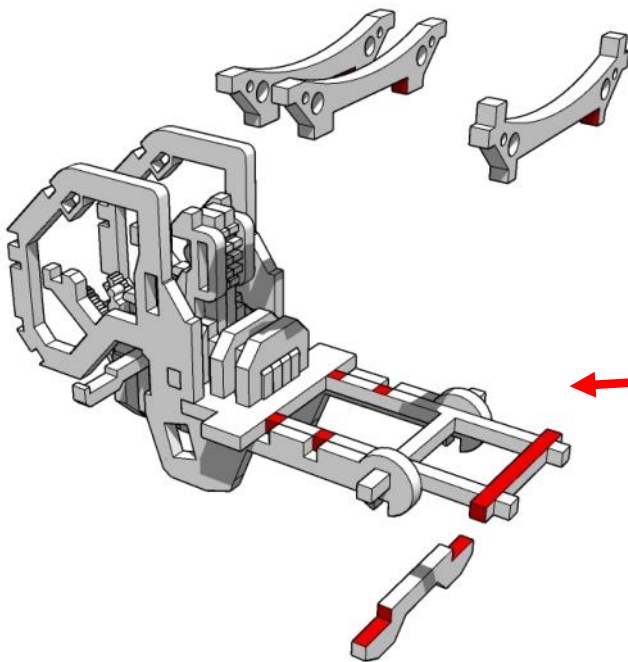
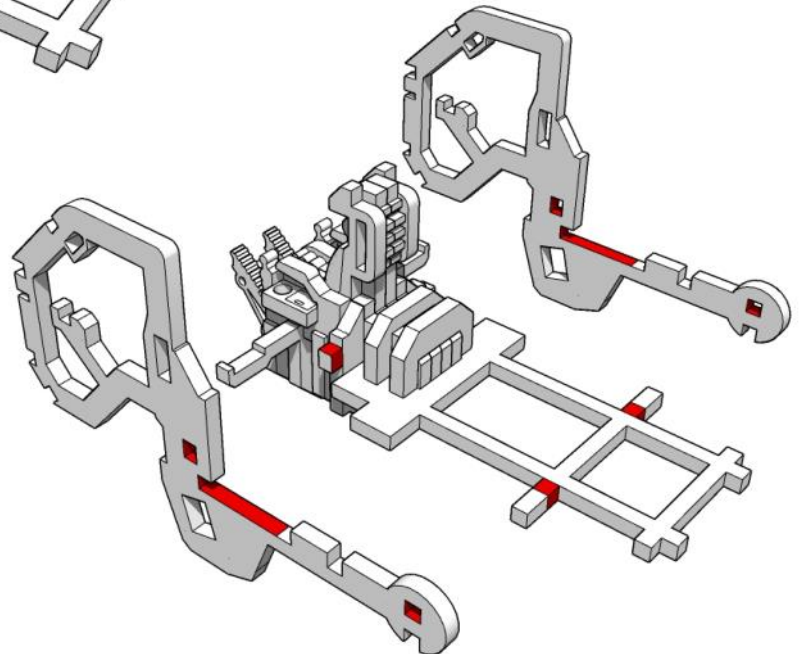
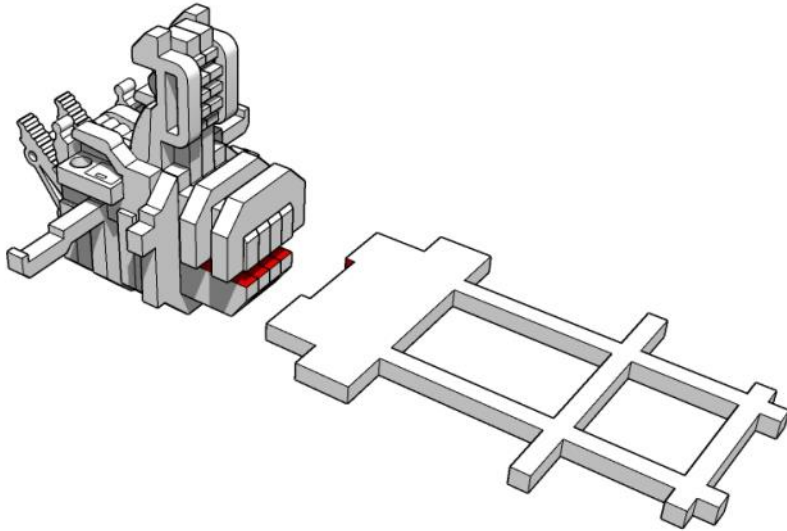

NOTE THAT IF YOU HAVE A DIFFERENT
VERSION OF THE HUMPTI (SUCH AS THE
DUMPTRUCK, OR TRANSPORTER), THEY
MAY CALL FOR DIFFERENT PARTS HERE.

THIS WILL BE MADE OBVIOUS IN THEIR
OWN RESPECTIVE INSTRUCTIONS.

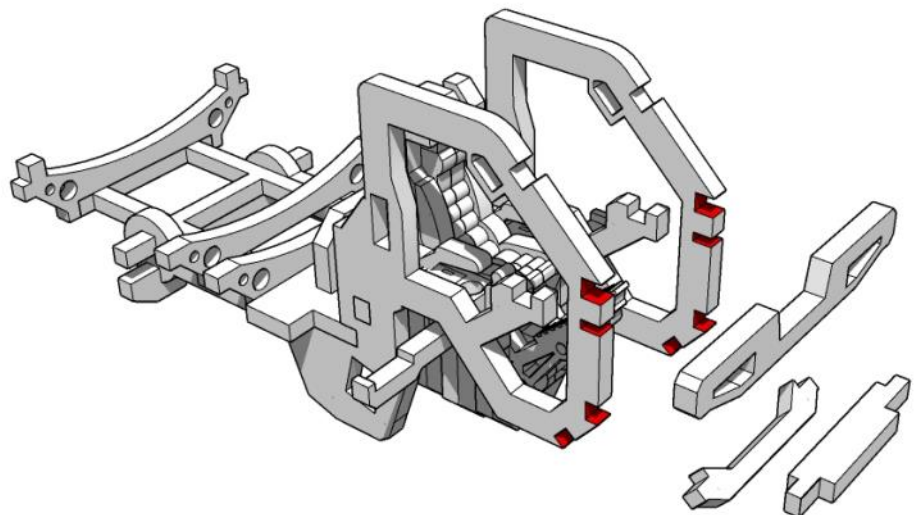

MINIATURE SCENERY

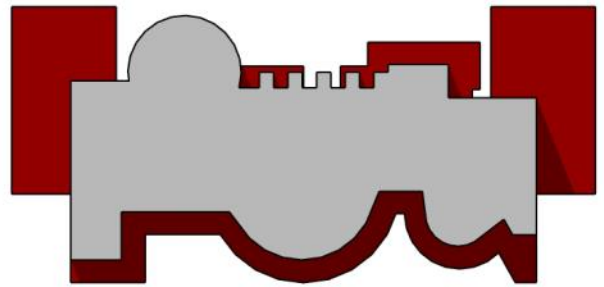
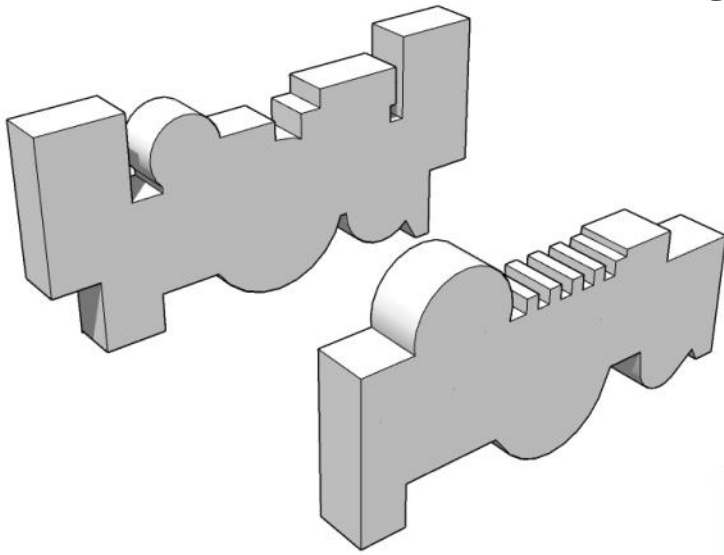

THE INSTRUMENT PANEL IS A BIT FIDDLY TO FIT, BUT IT DOES GO IN, I ASSURE YOU.

THIS IS ALSO A GOOD TIME TO PAINT THE INSIDE OF THE COCKPIT, AS IT WILL BE DIFFICULT TO REACH LATER.

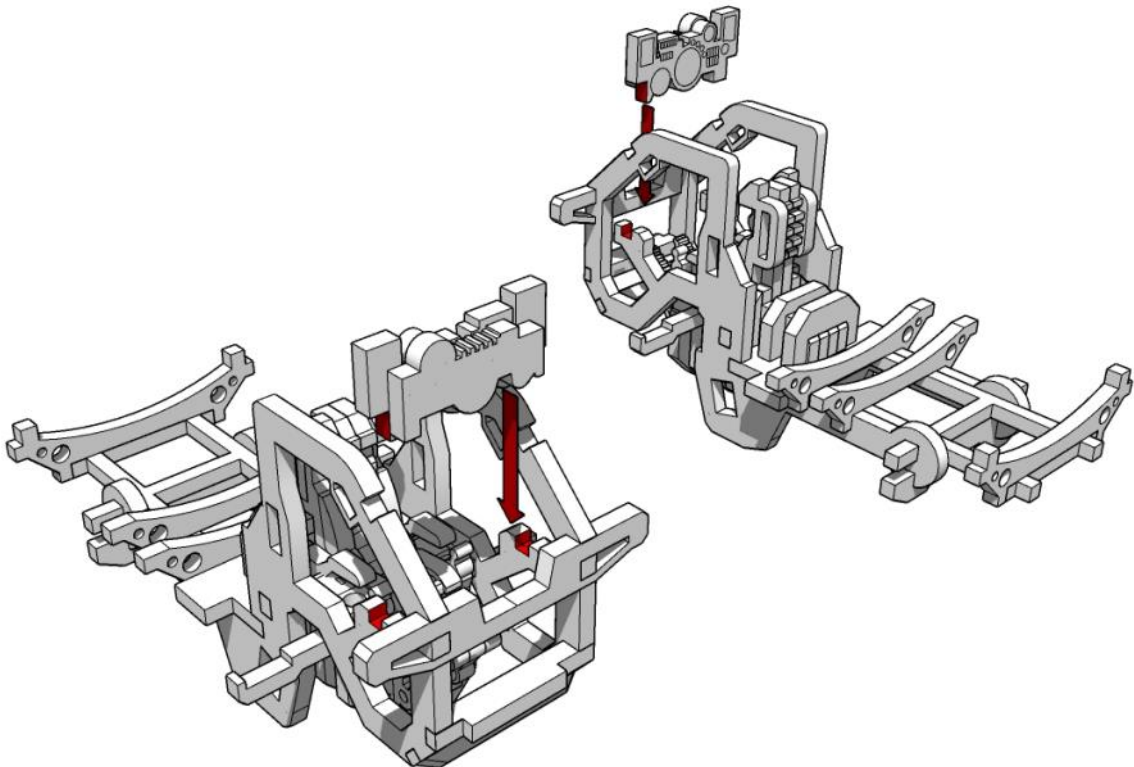

MINIATURE SCENERY

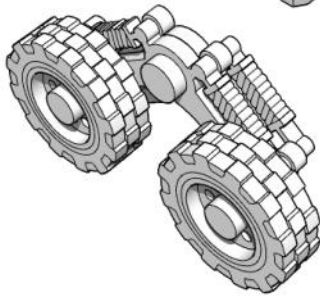
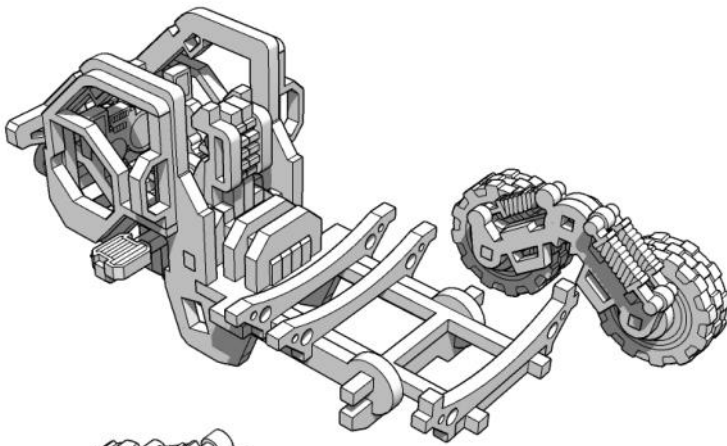
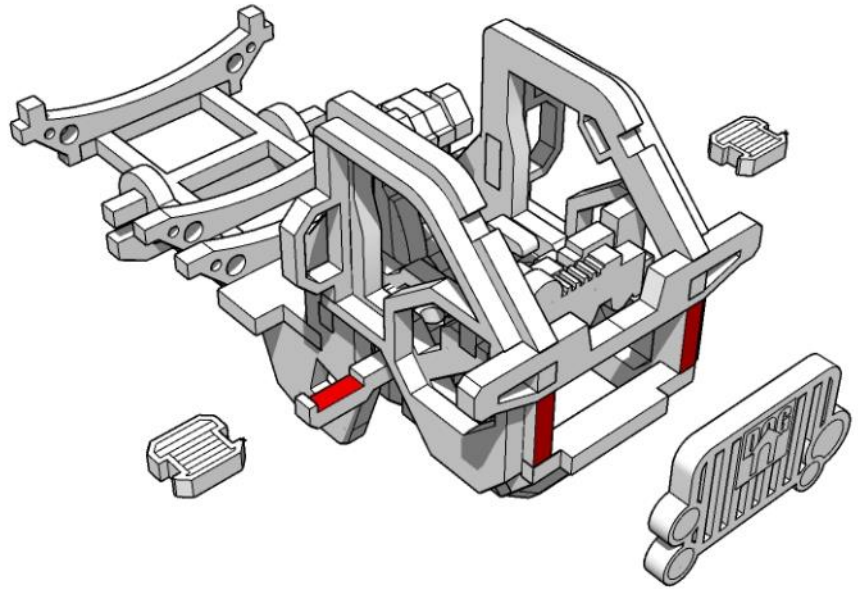
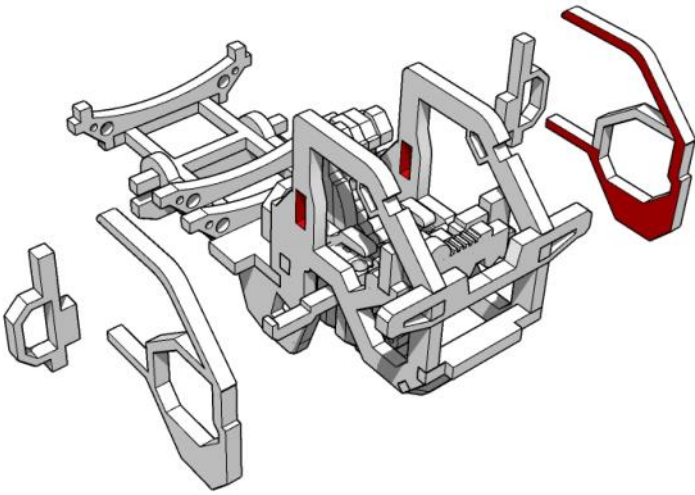

I SUGGEST LEAVING THE MODEL ON A
FLAT SURFACE TO DRY AT THIS POINT,
ENSURING THAT ALL OF THE WHEELS
TOUCH THE GROUND.

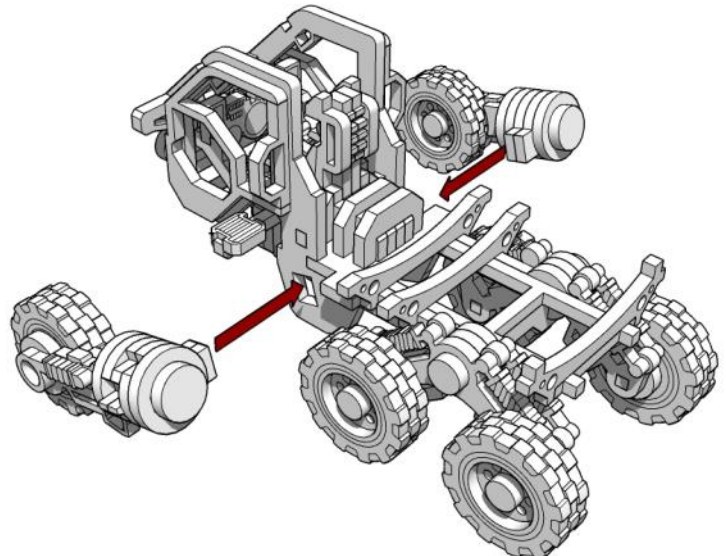

MINIATURE SCENERY

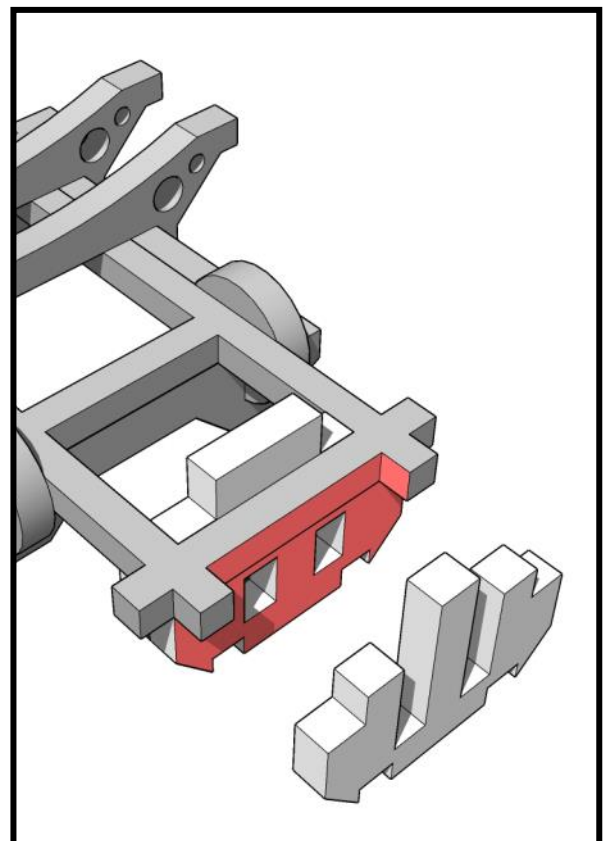
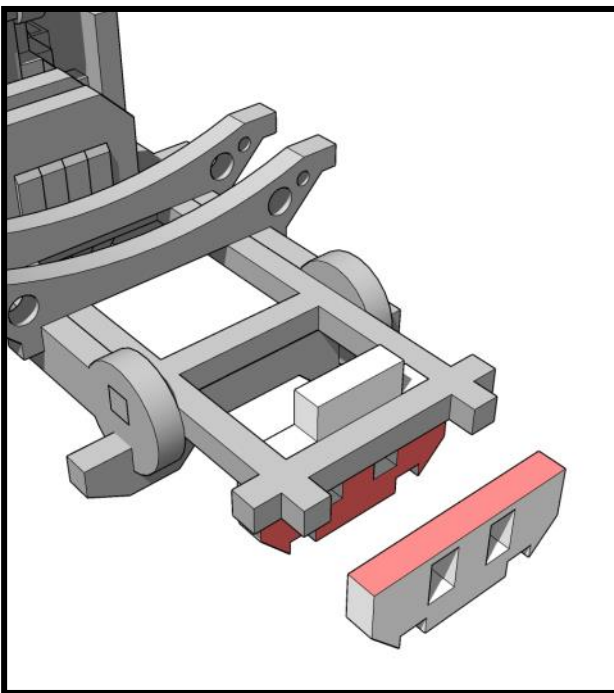
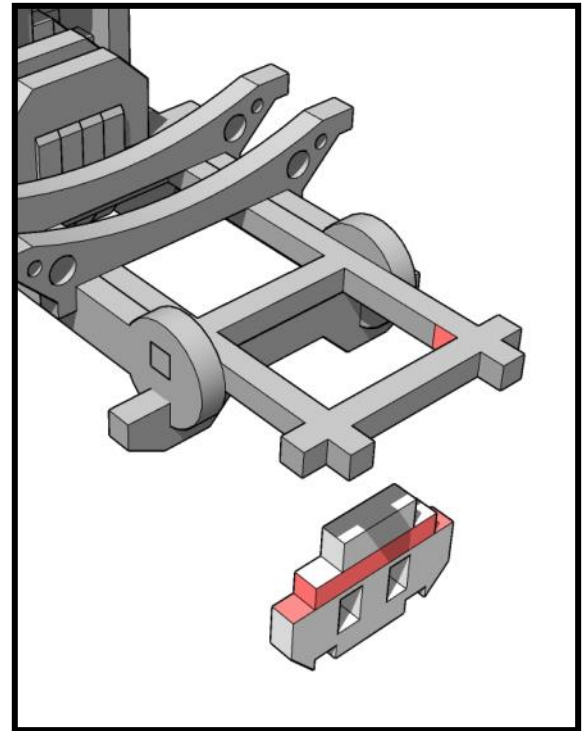
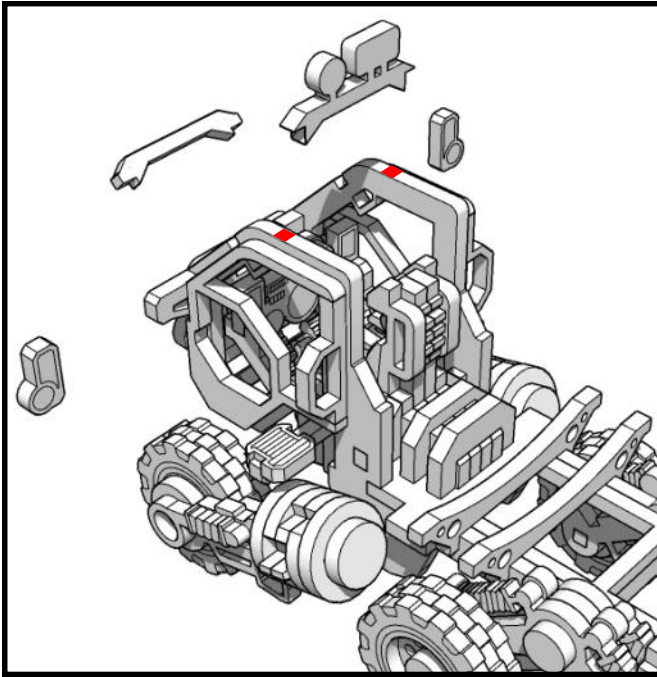

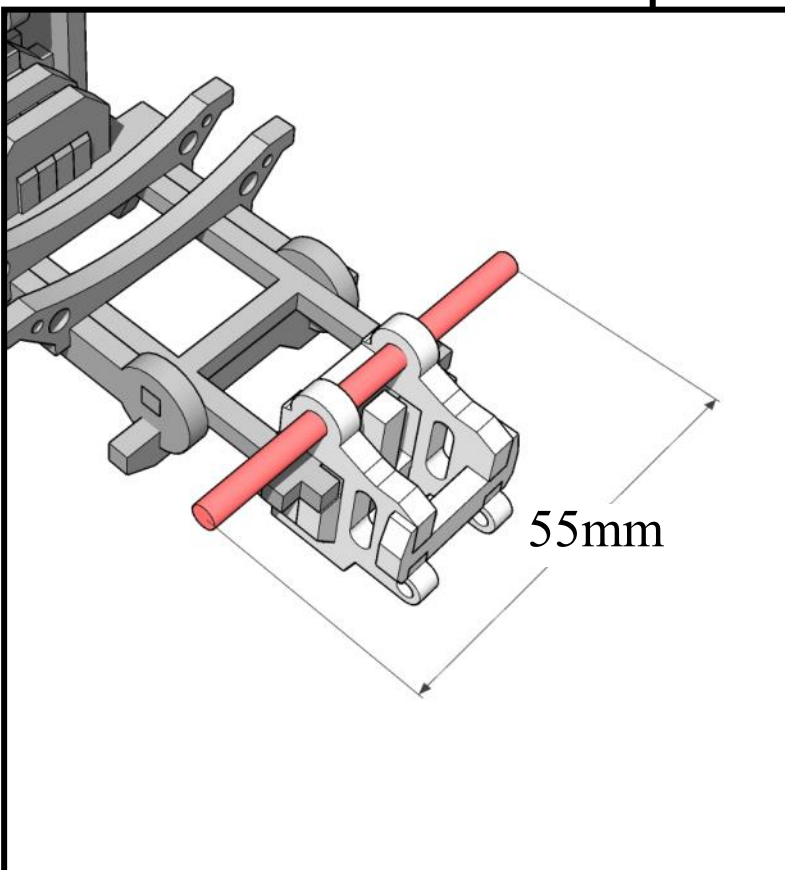
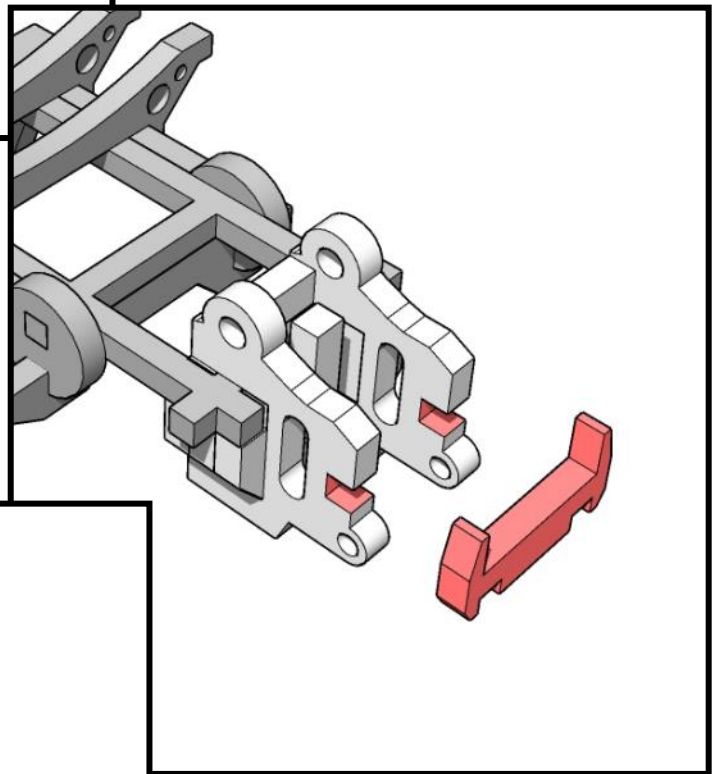
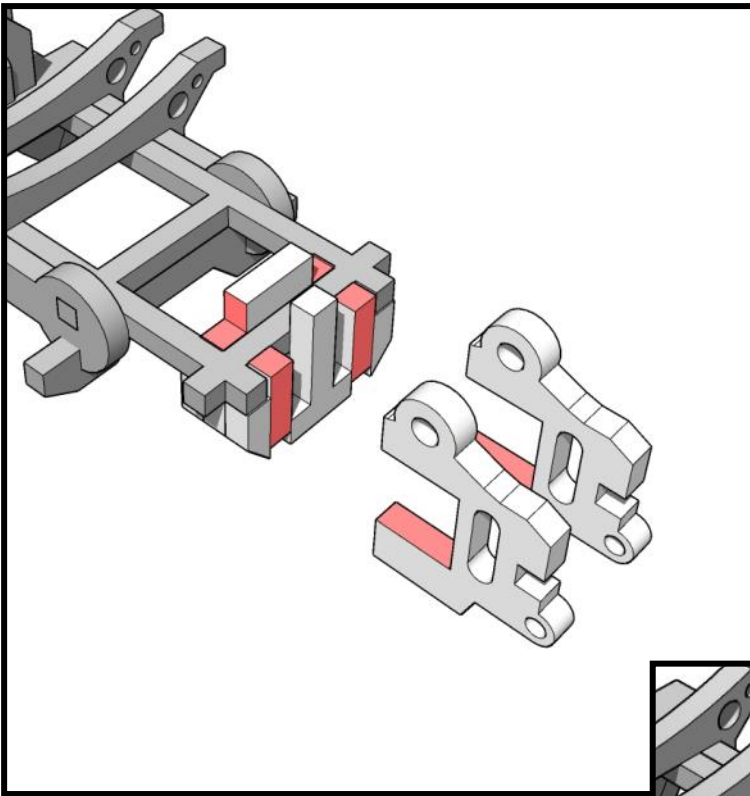

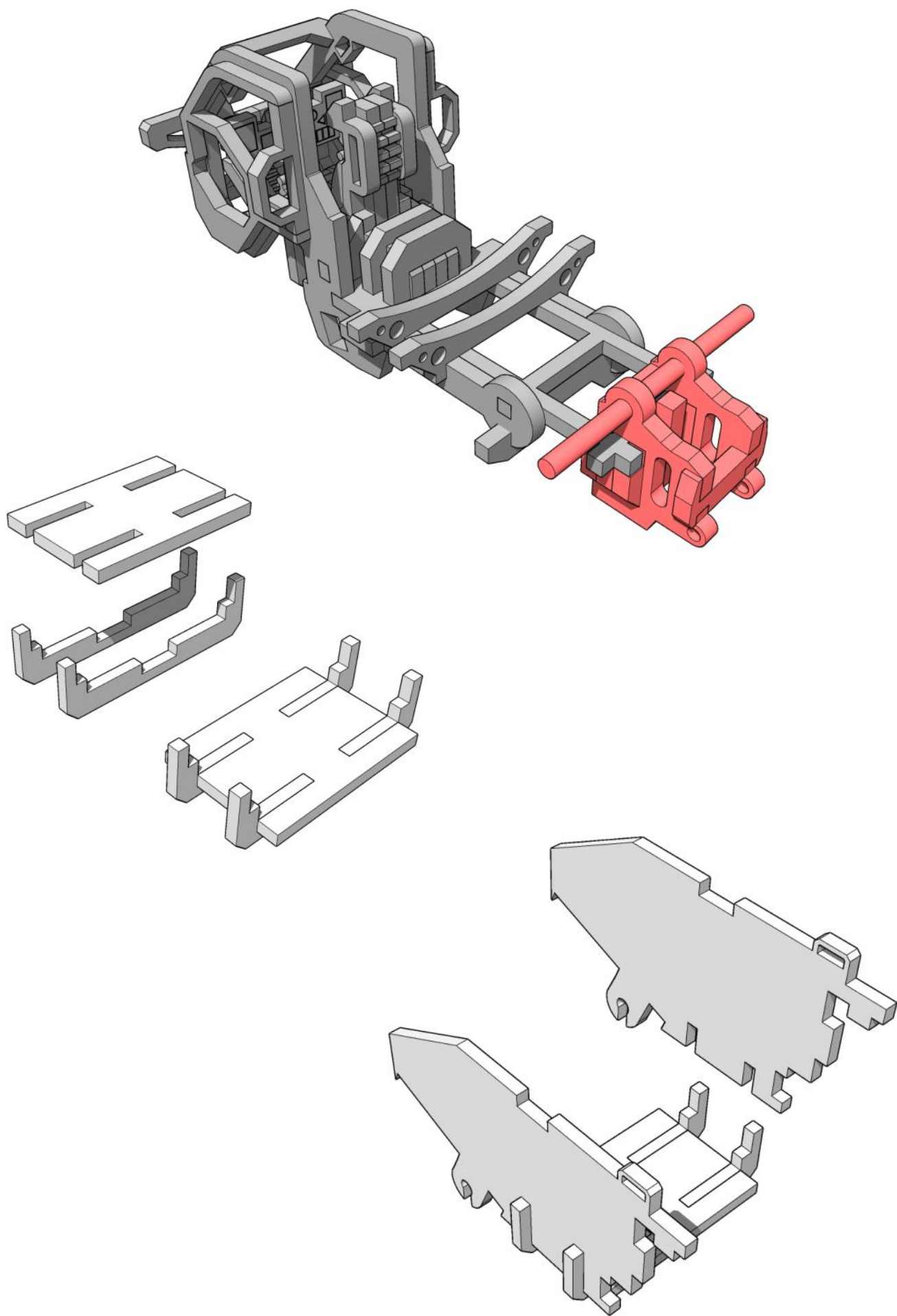

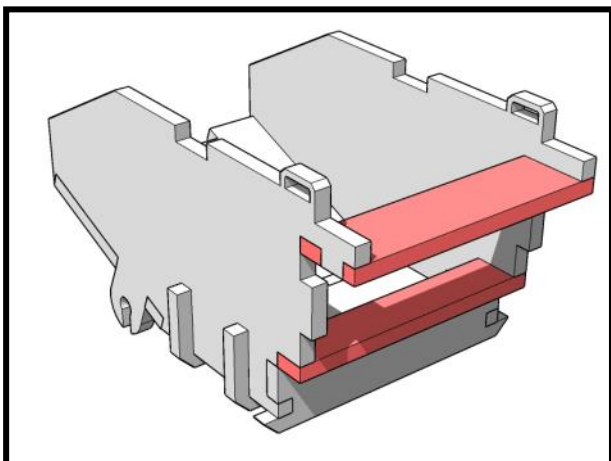
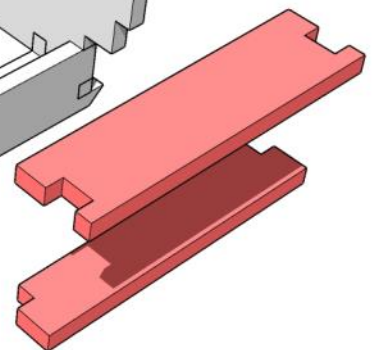
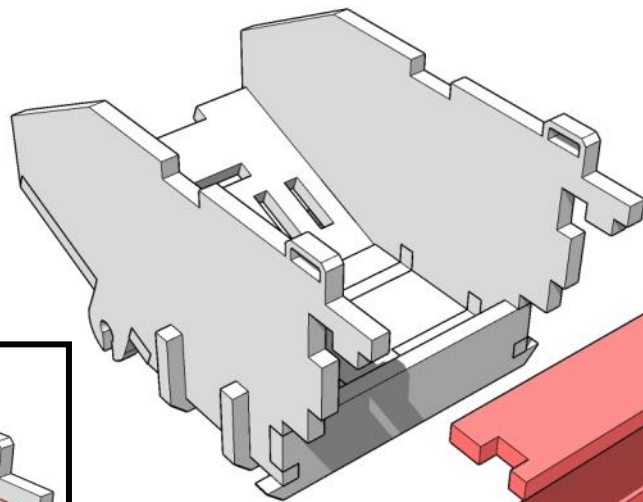
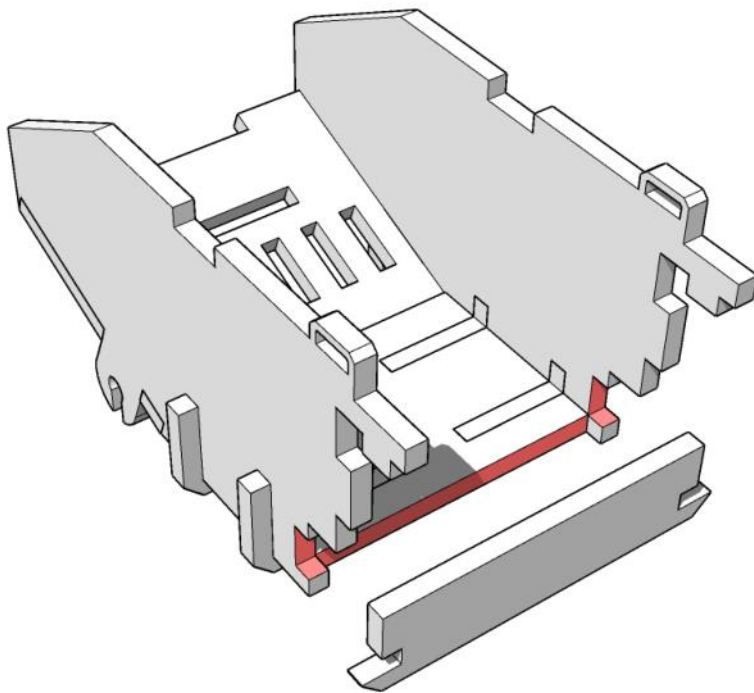
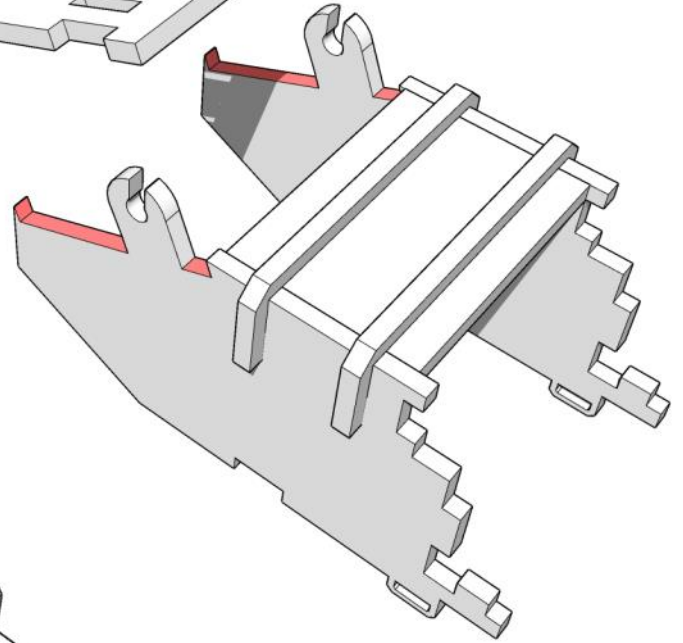
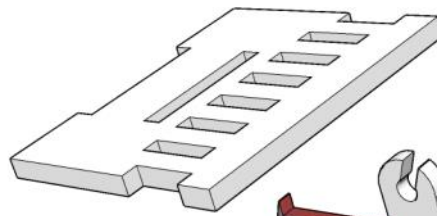

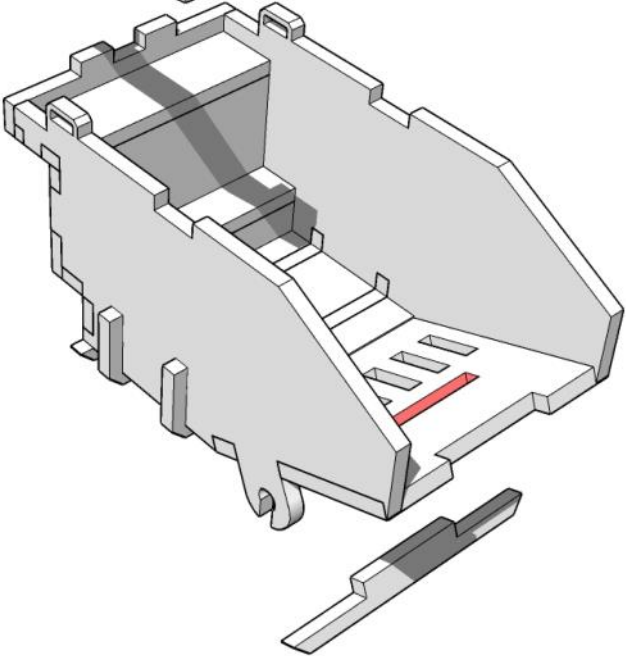
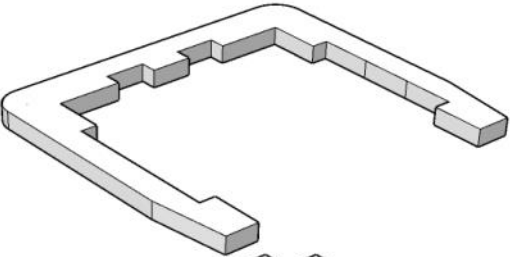
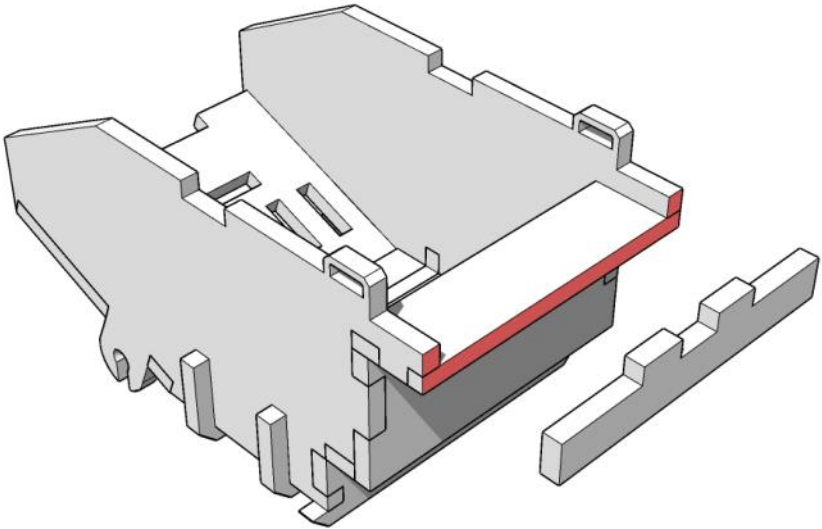
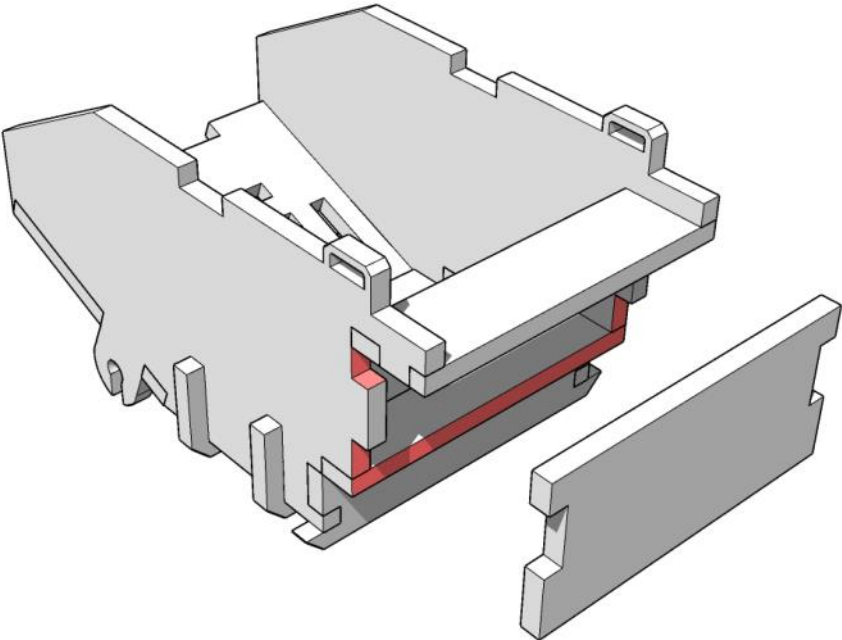

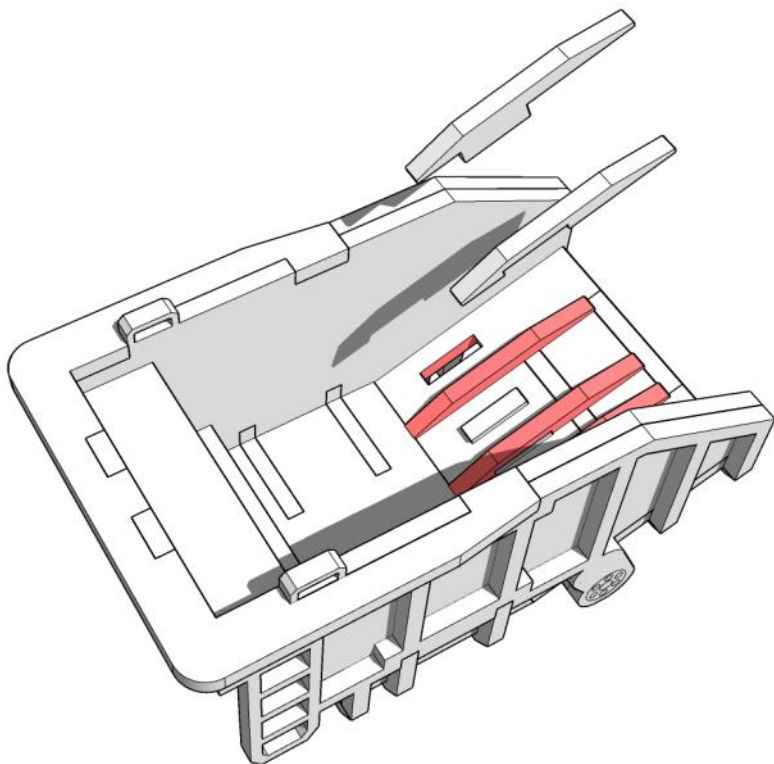
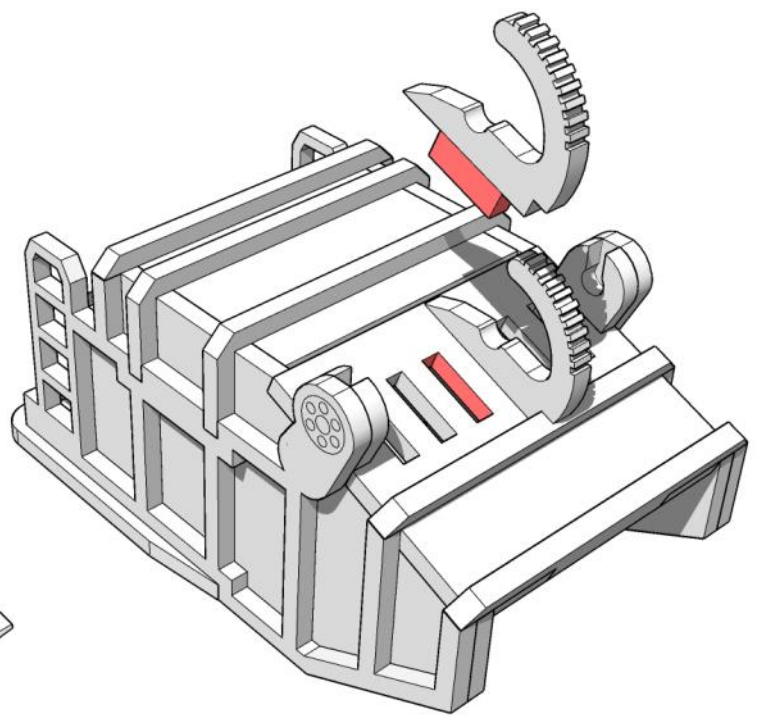
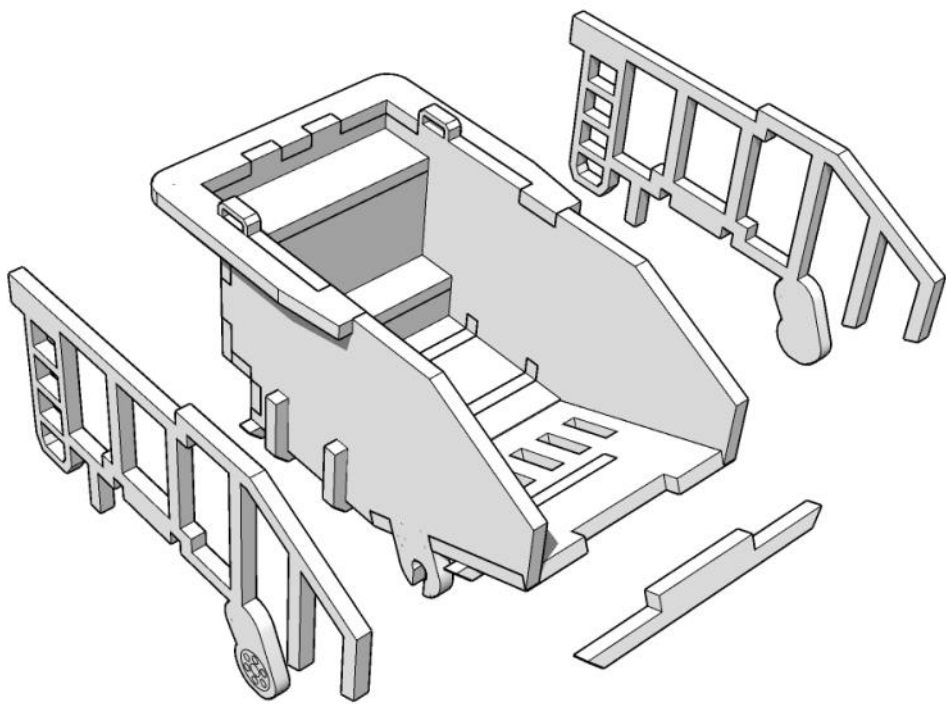

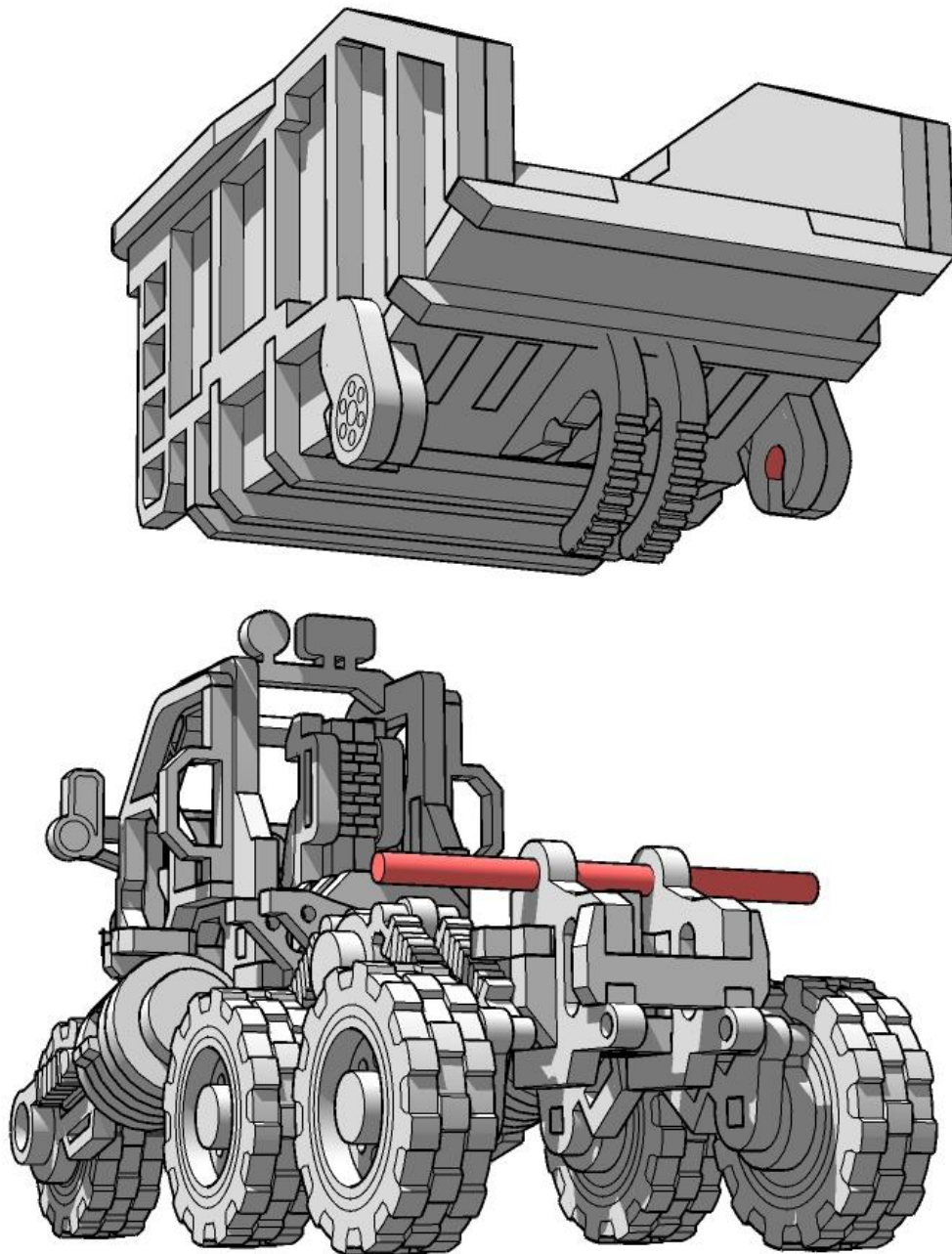

If you don't glue this assembly, it should tip backward and forwards.