

Preparation

Once you clear some table space you will need a small pair of side cutters and glue (PVA, wood glue, hobby glue). A file or small piece of sandpaper can be used to clean along any edges that have burr.

Step 1 will require glue - however, the rest of the model can be put together without glue in order to familiarise yourself with construction.

Getting Started

- i. Remove all the parts out of the board with your cutters.
- ii. Go over each part again with the cutters removing as much of the tabs as possible (this greatly reduces the time needed with the file or sand paper).
- iii. Use a file or sand paper last to completely remove the tabs that might remain.

Construction

Slot the parts together as shown by the pictures below, applying glue wherever there is a connection.

Allow the model to completely dry before painting it.

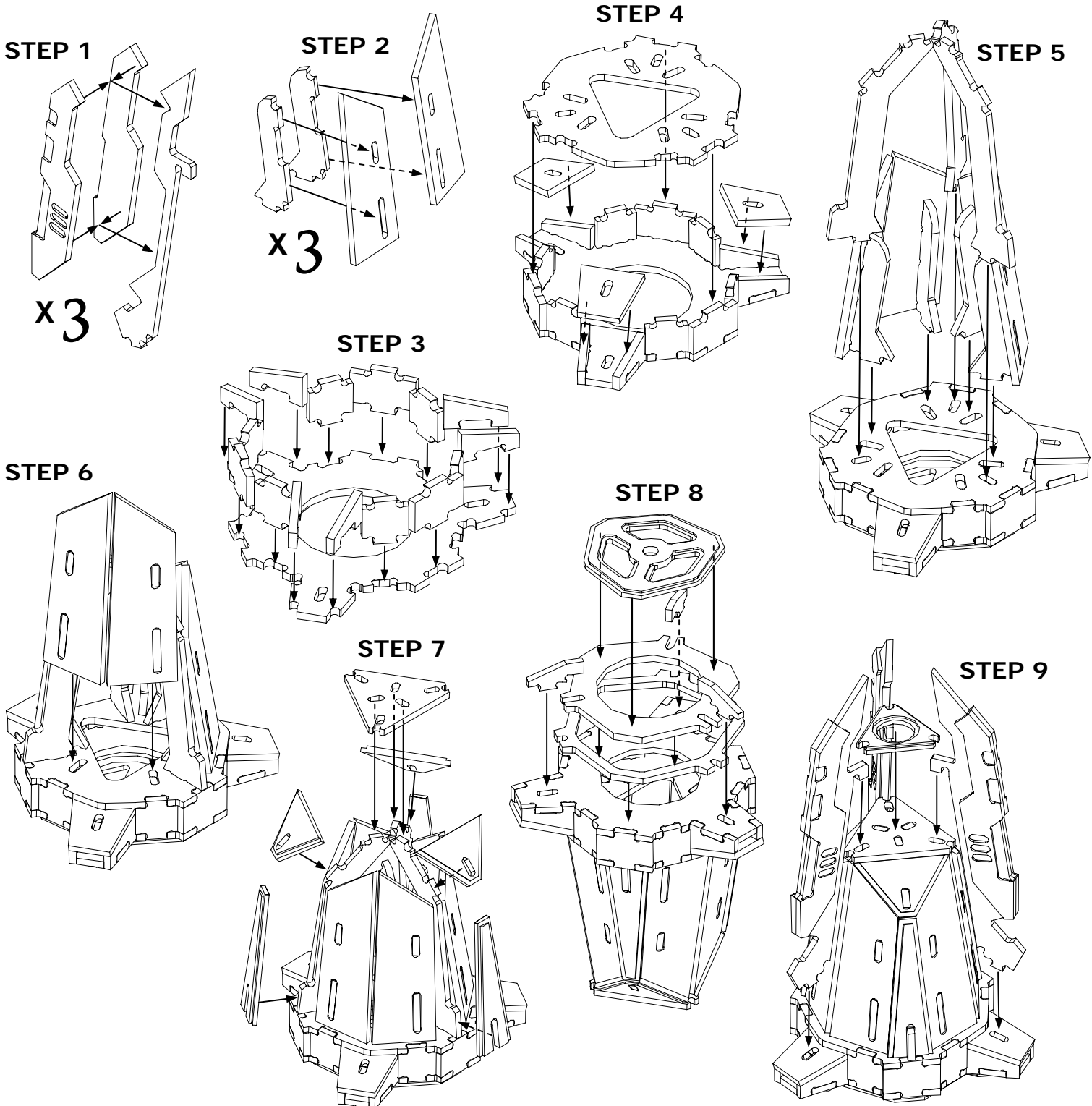

PAINTING

At www.miniaturescenery.com we provide a detailed and easy to follow illustrated guide for painting the Troop Lander. We also share simple, effective painting techniques that you can use to get your model looking its best.